

## List of Figures

**Figure S1:** Greater Mesopotamia during the middle of the third millennium, with location of bent axis temples, map by Martin Sauvage and Pascal Butterlin.



**Figure S2:** Mari, City II temples, Mission archéologique française de Mari, Pascal Butterlin.

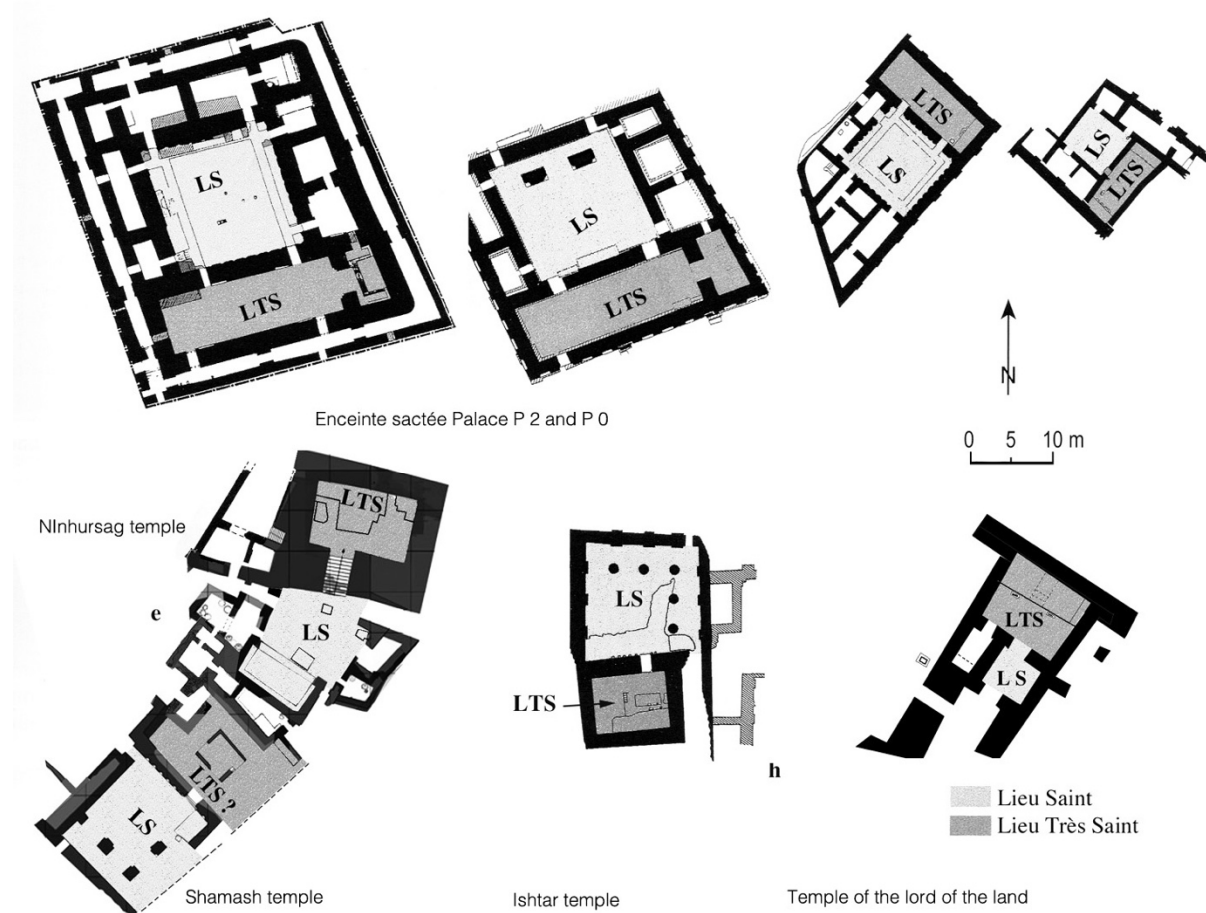


Figure S3: Mari, Ninhursag temple, Mission archéologique française de Mari.

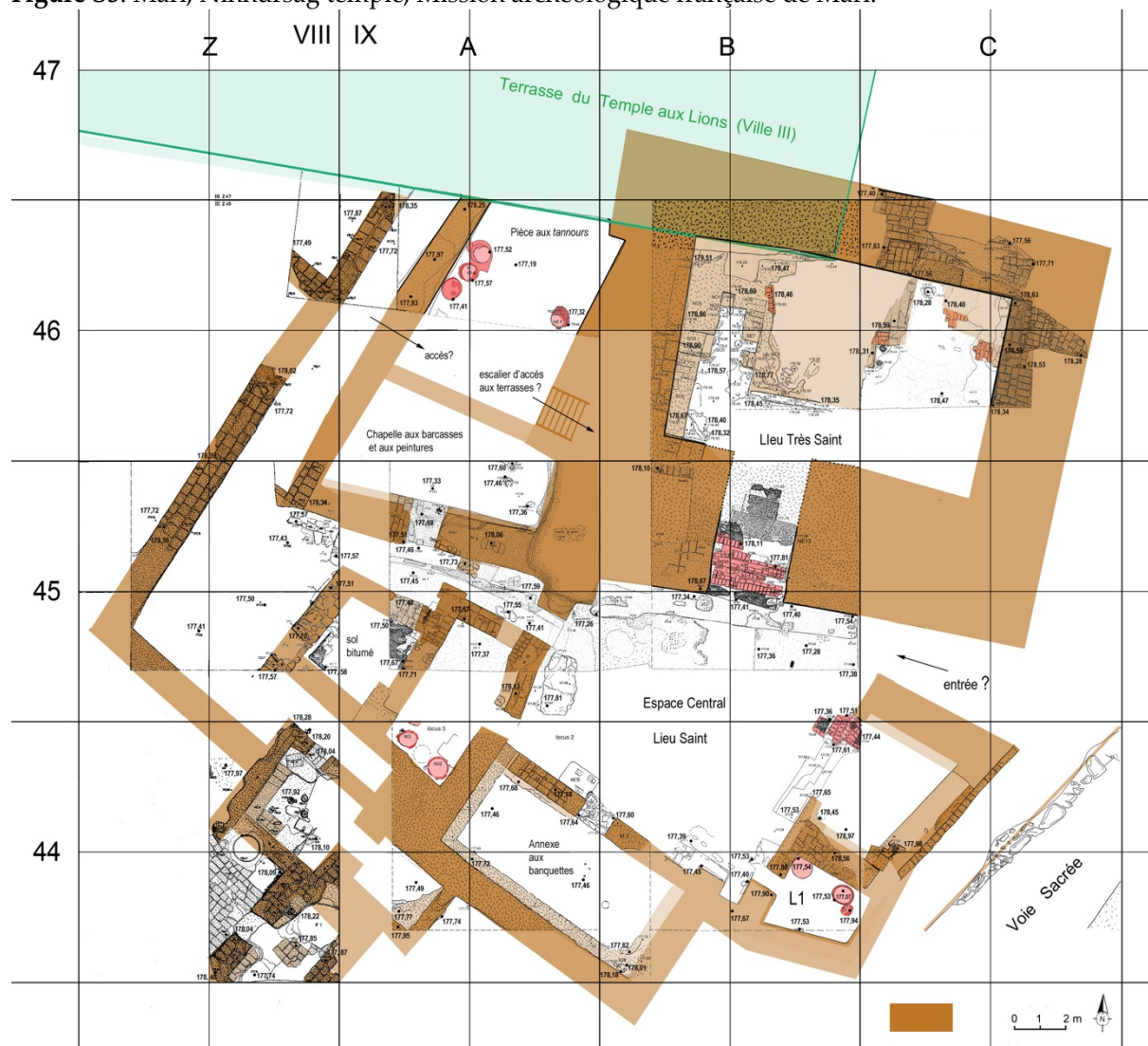
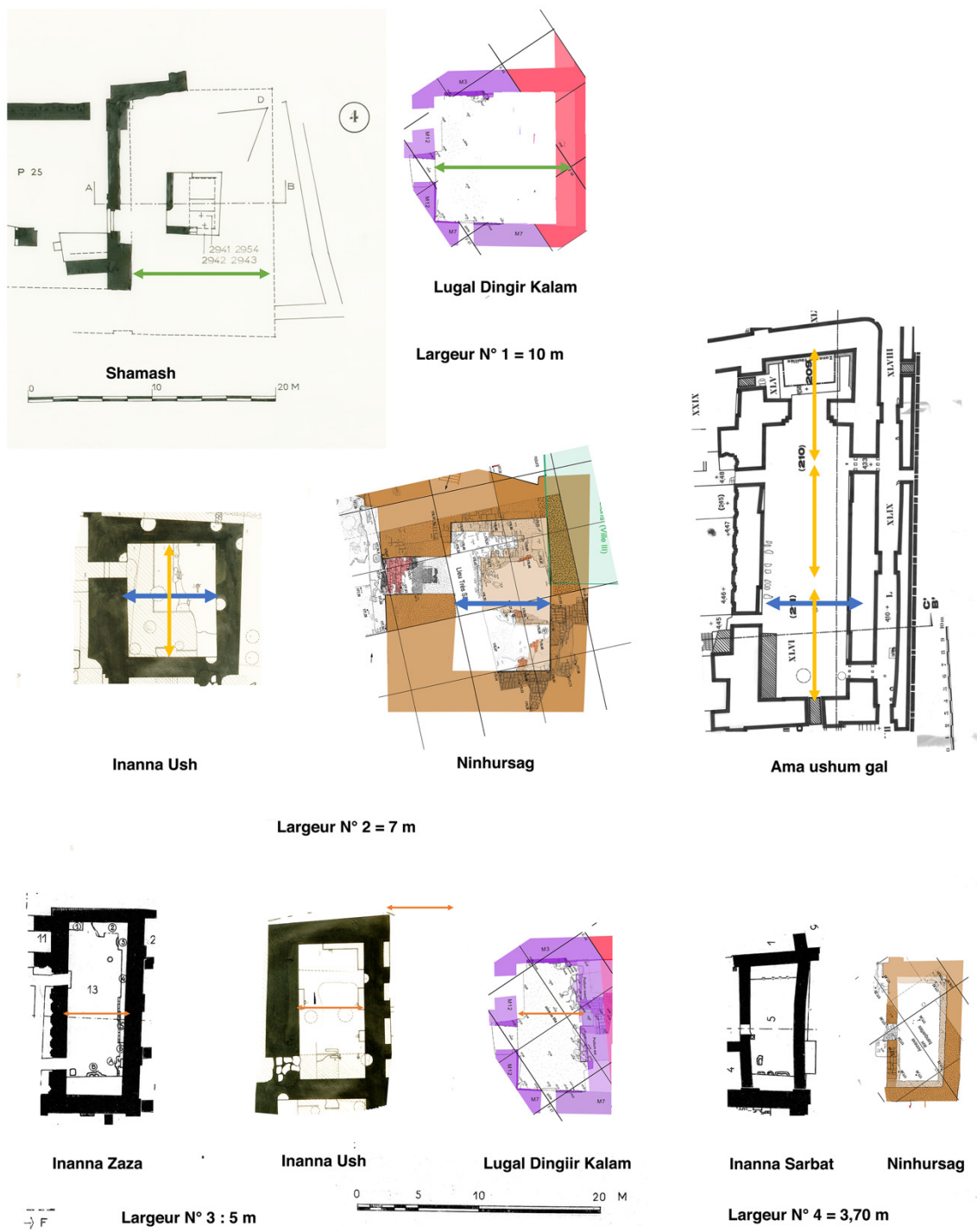
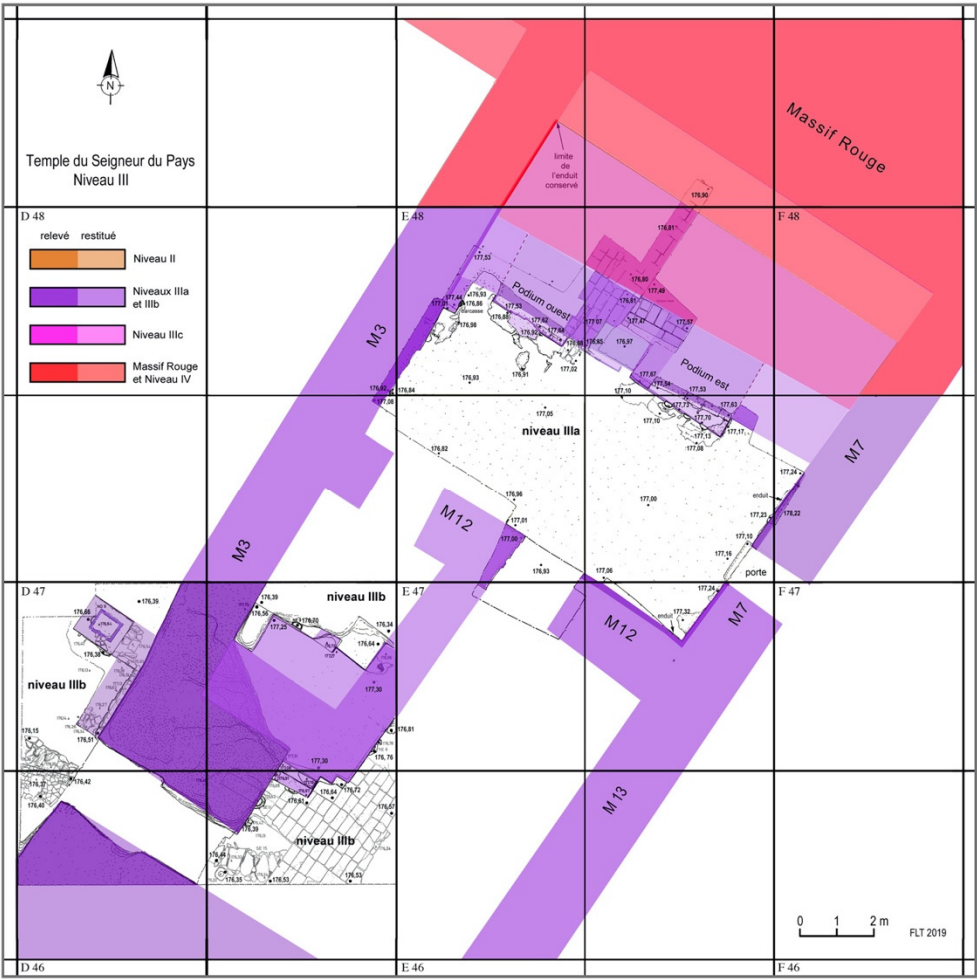


Figure S4: Mari, cellae of city II, Mission archéologique française de Mari, Pascal Butterlin.

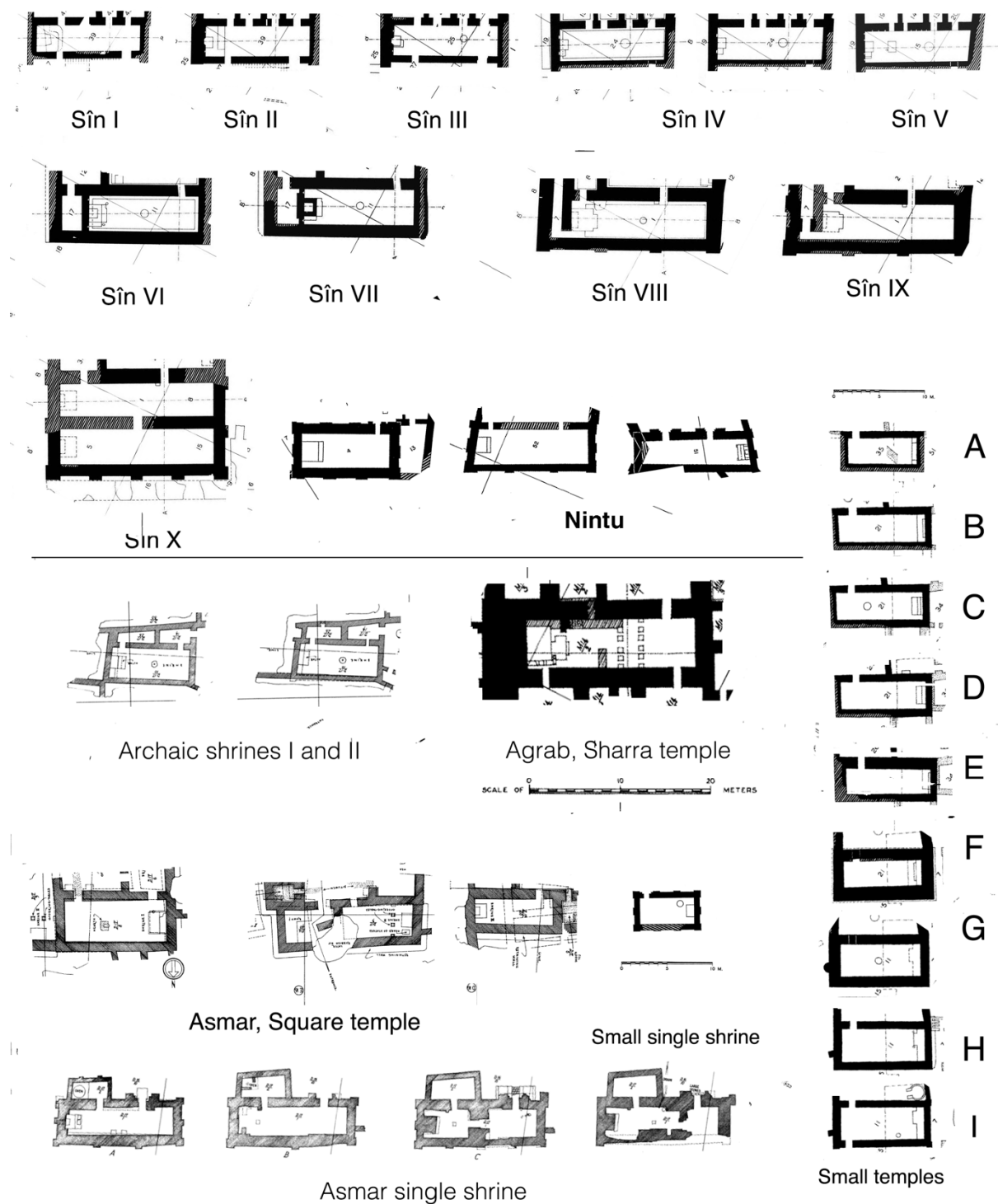




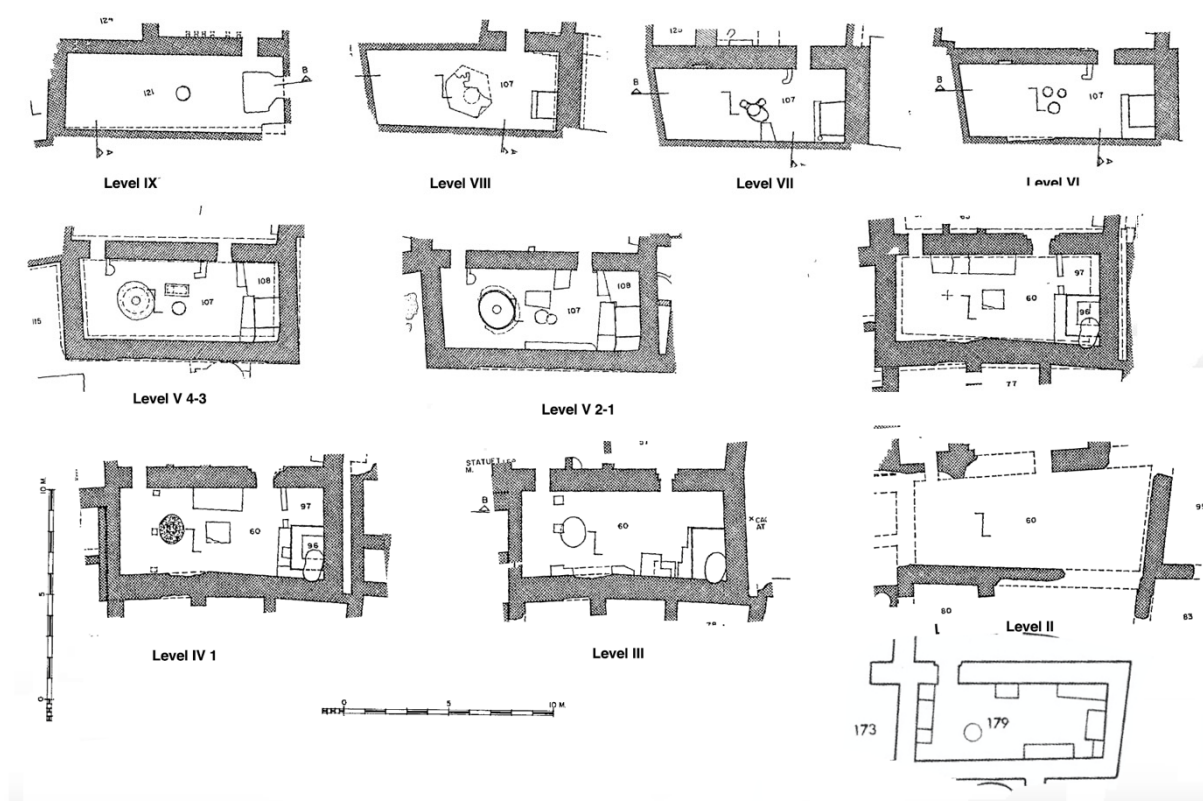
**Figure S5:** Mari, temple of the lord of the land, Mission archéologique française de Mari, Pascal Butterlin.



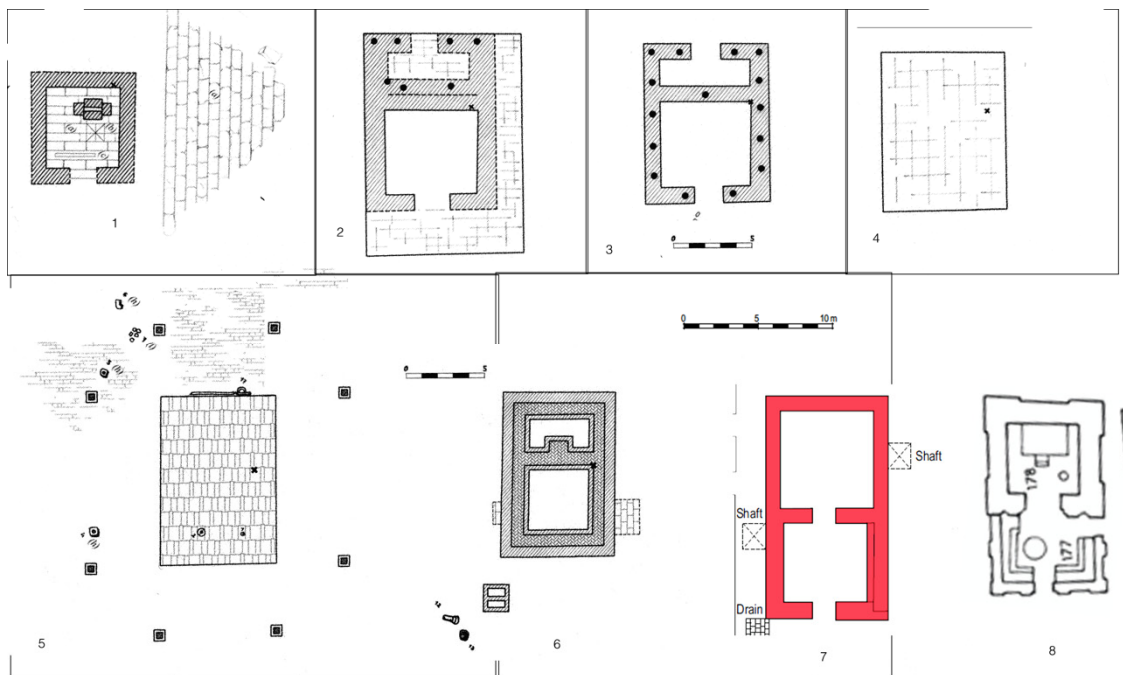
**Figure S6:** Early Dynastic cellae in the Diyala, at scale, author's synthesis, after Delougaz and Lloyd 1942, Pascal Butterlin.



**Figure S7:** Nippur North temple, author's synthesis, after Haines 1978, Pascal Butterlin.

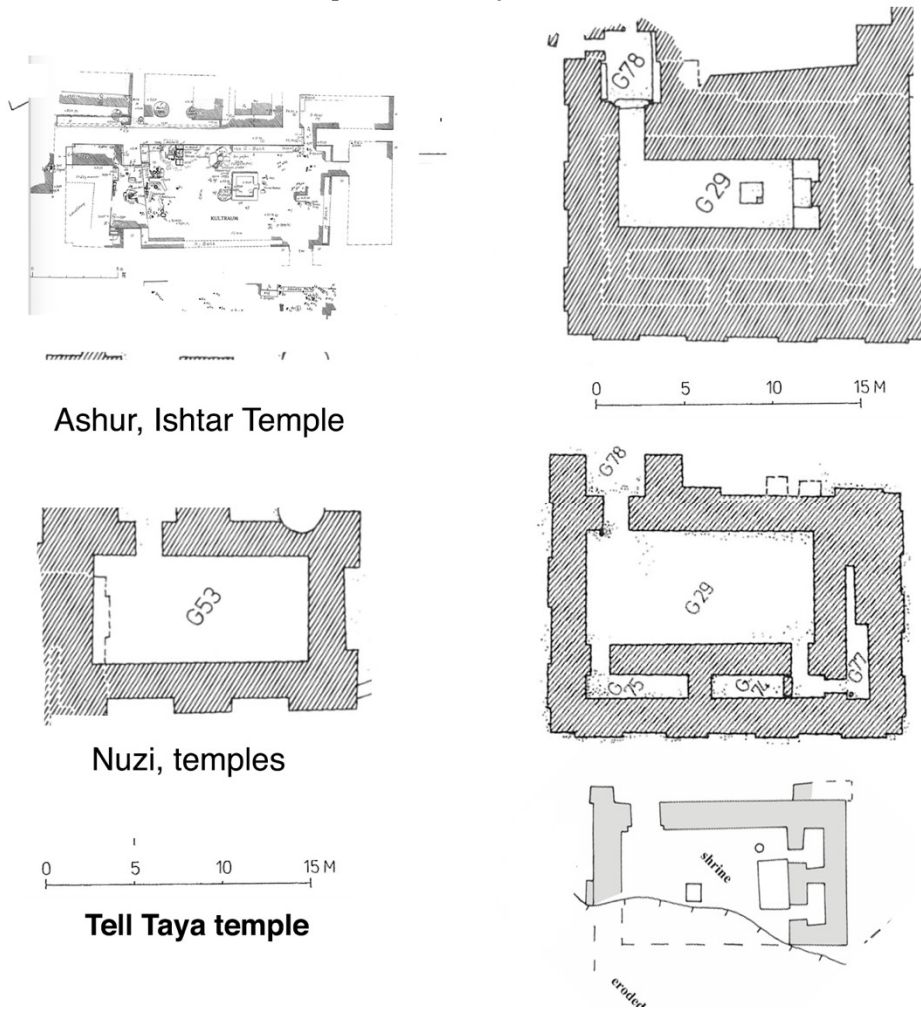


**Figure S8:** Square temples from Early Dynastic temples from southern Mesopotamia, author's synthesis, after Marchesi and Marchetti 2011, Pascal Butterlin, 1-6 Tello, Ningirsu temple ; 7, Adab ; 8, Nippur Inanna temple.





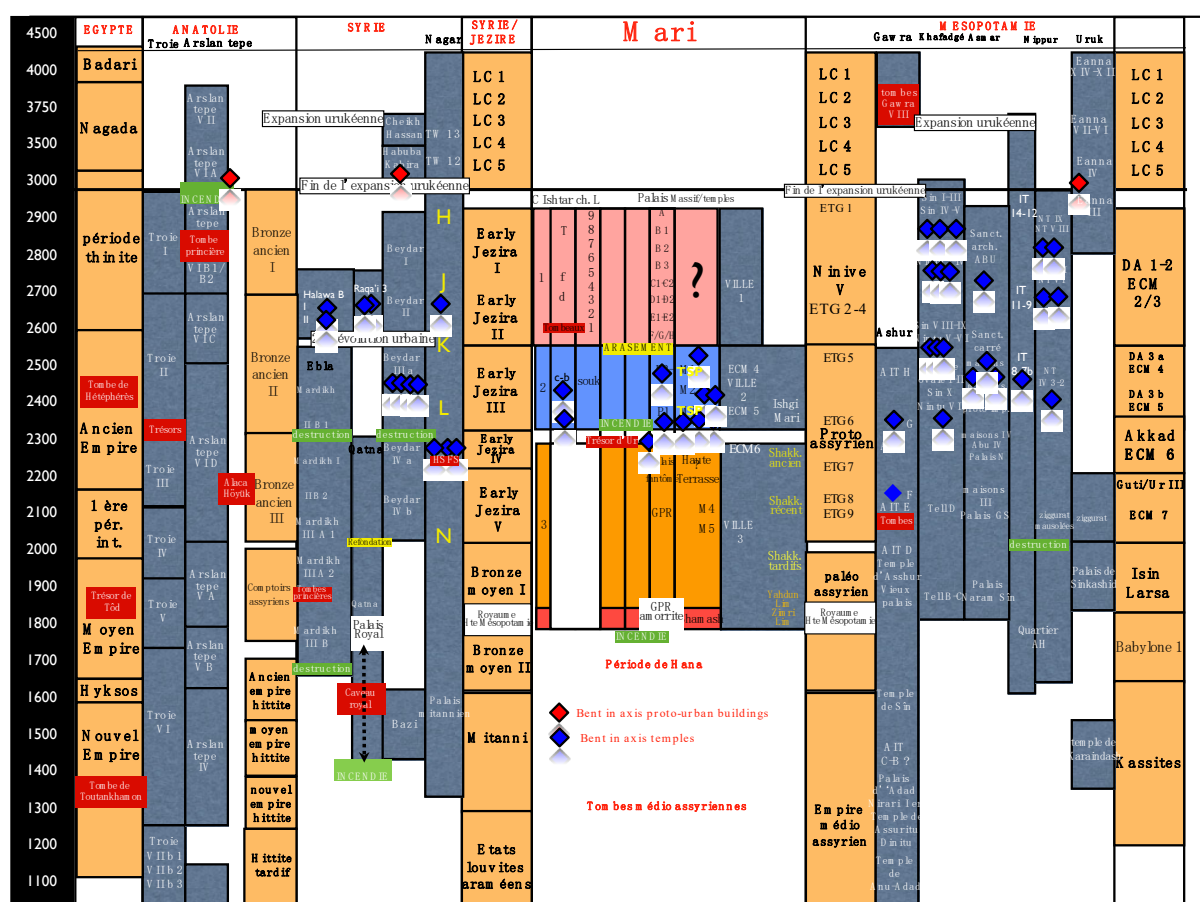
**Figure S9:** Nuzi Ashur Ishtar temple, author's synthesis, Pascal Butterlin.



**Figure S10:** Nagar Kingdom shrines, author's synthesis, Pascal Butterlin, after Lebeau 2006 and 2020, courtesy Marc Lebeau



Figure S11: Chronological chart of the third millennium, Pascal Butterlin.

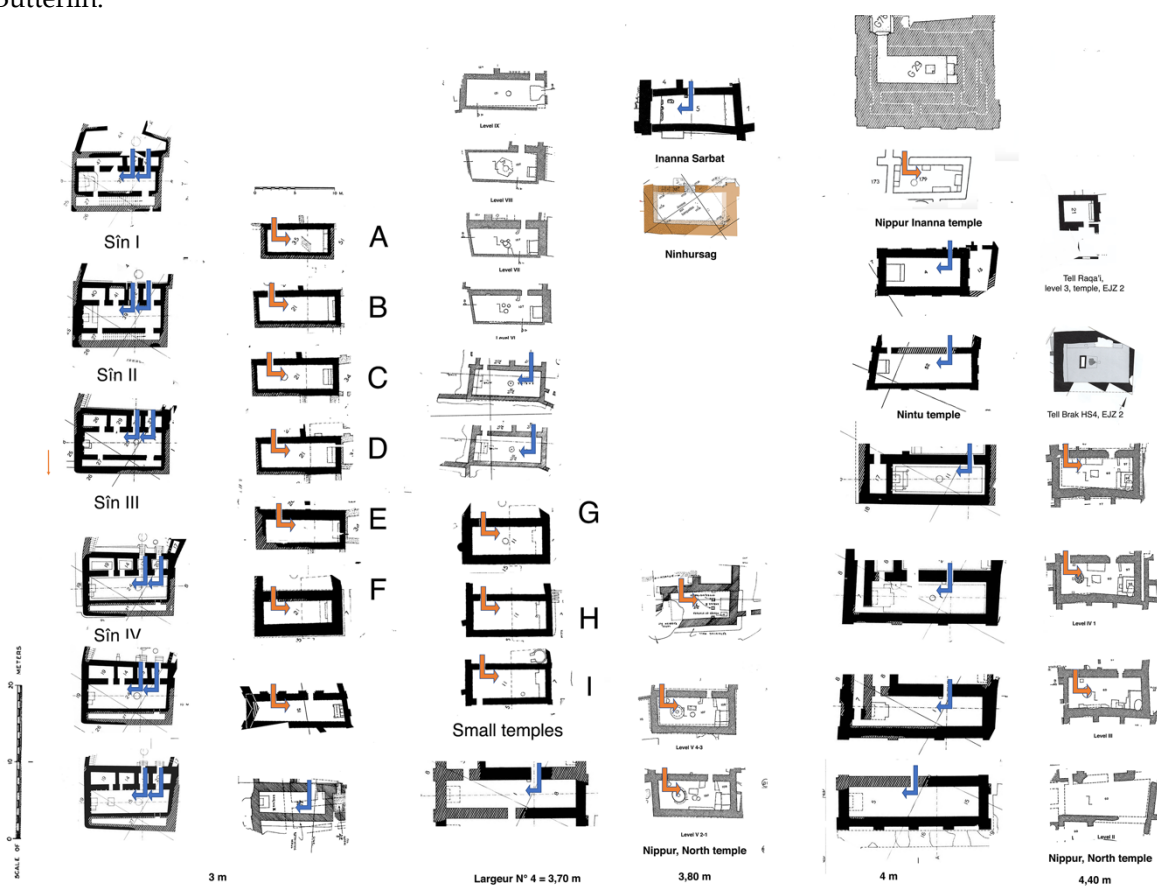


**Figure S12:** Favissa of the temple of the lord of the land, Mission archéologique française de Mari, Pascal Butterlin.





**Figure S13:** Bent axis temples of Mesopotamia 1, cellae, ordered by width, composite board, Pascal Butterlin.



**Figure S14:** Bent axis temples of Mesopotamia 2, cellae, ordered by width, composite board, Pascal Butterlin.



**Figure S15:** Uruk reception rooms, author's synthesis after Eichmann 2007, Pascal Butterlin.

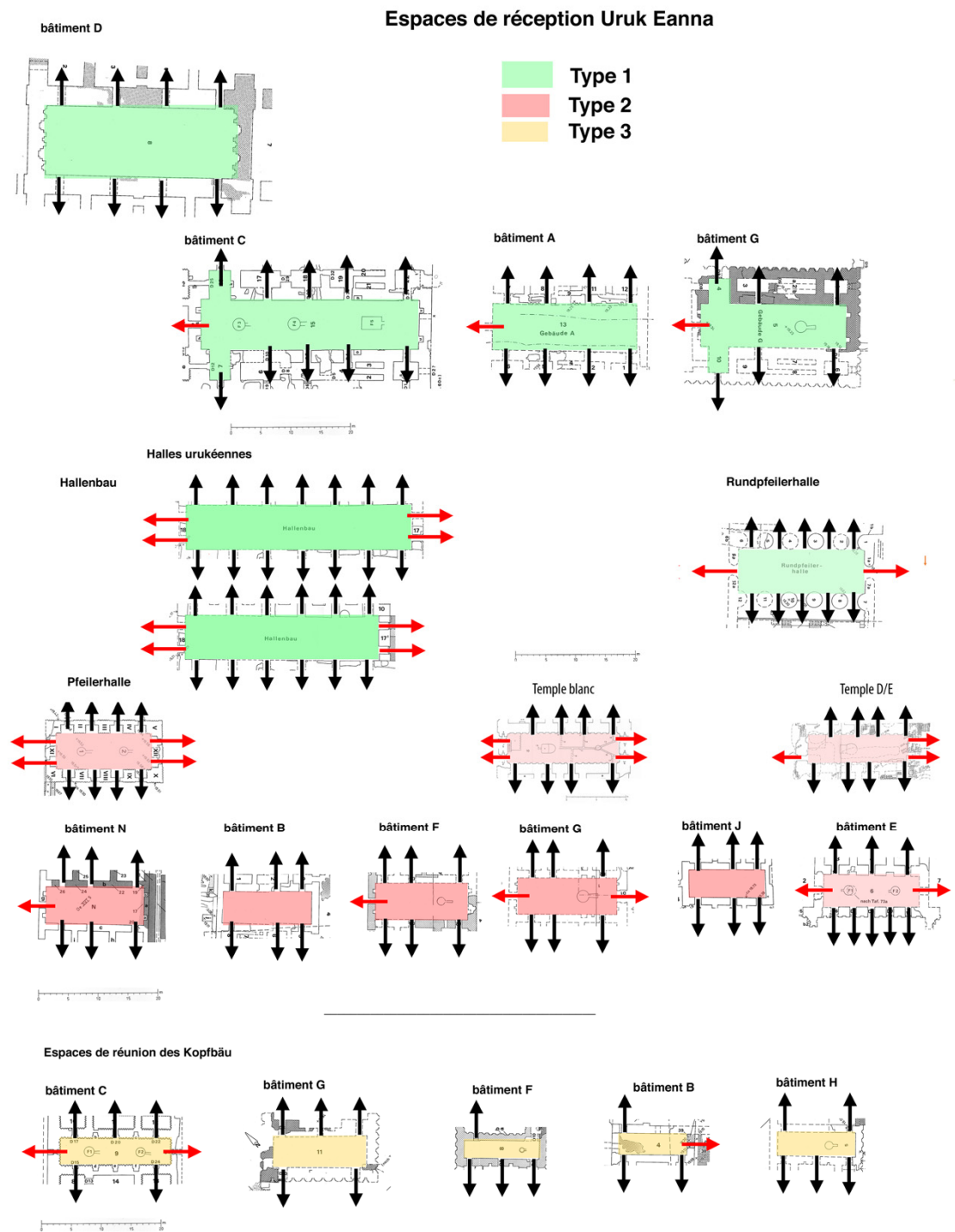
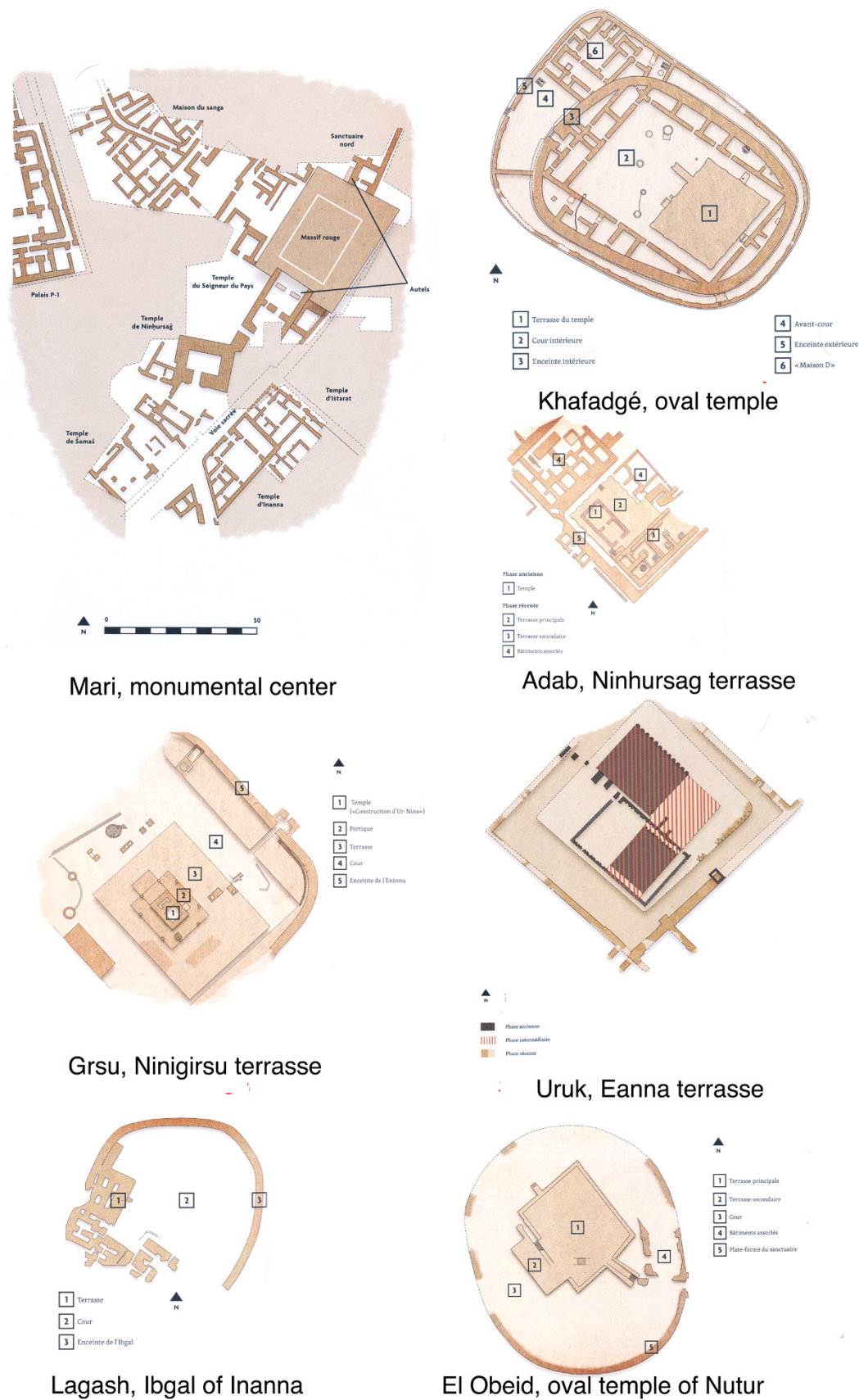


Figure S16: Mesopotamian High terraces and their environment, composite board, Pascal Butterlin.





**Figure S17:** Mari, Inanna Zaza temple, circulation pattern, Pascal Butterlin

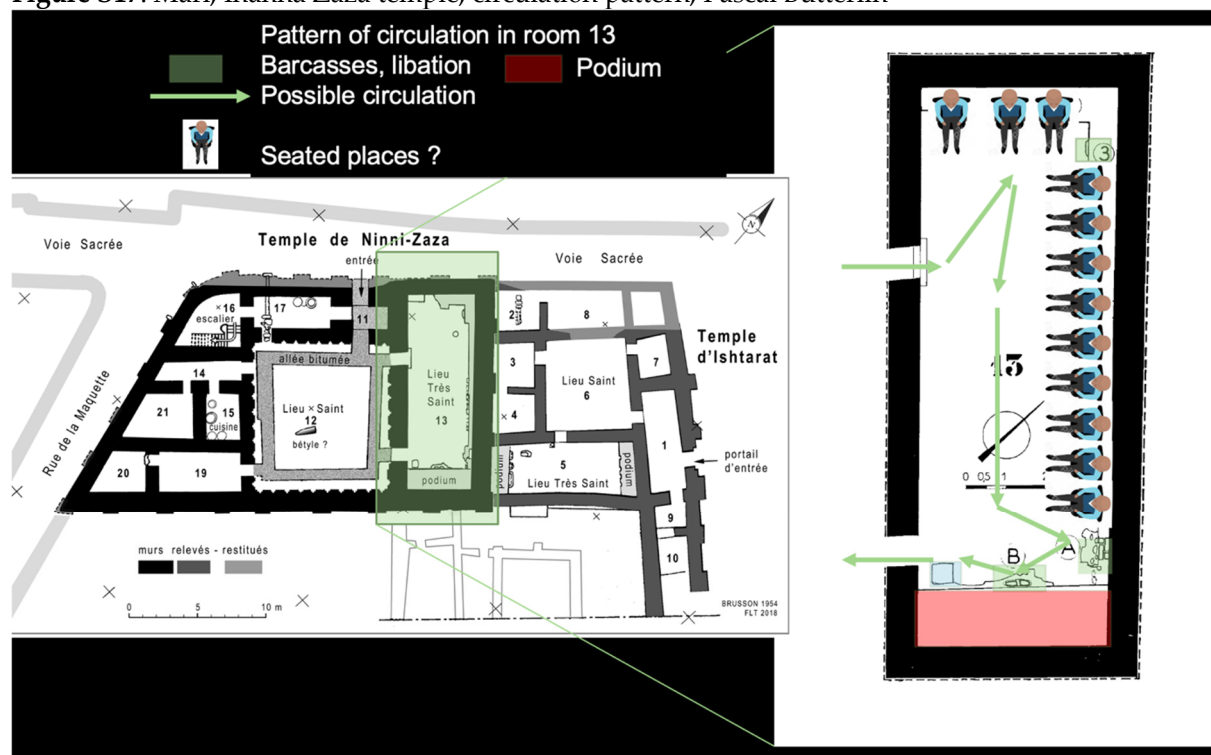
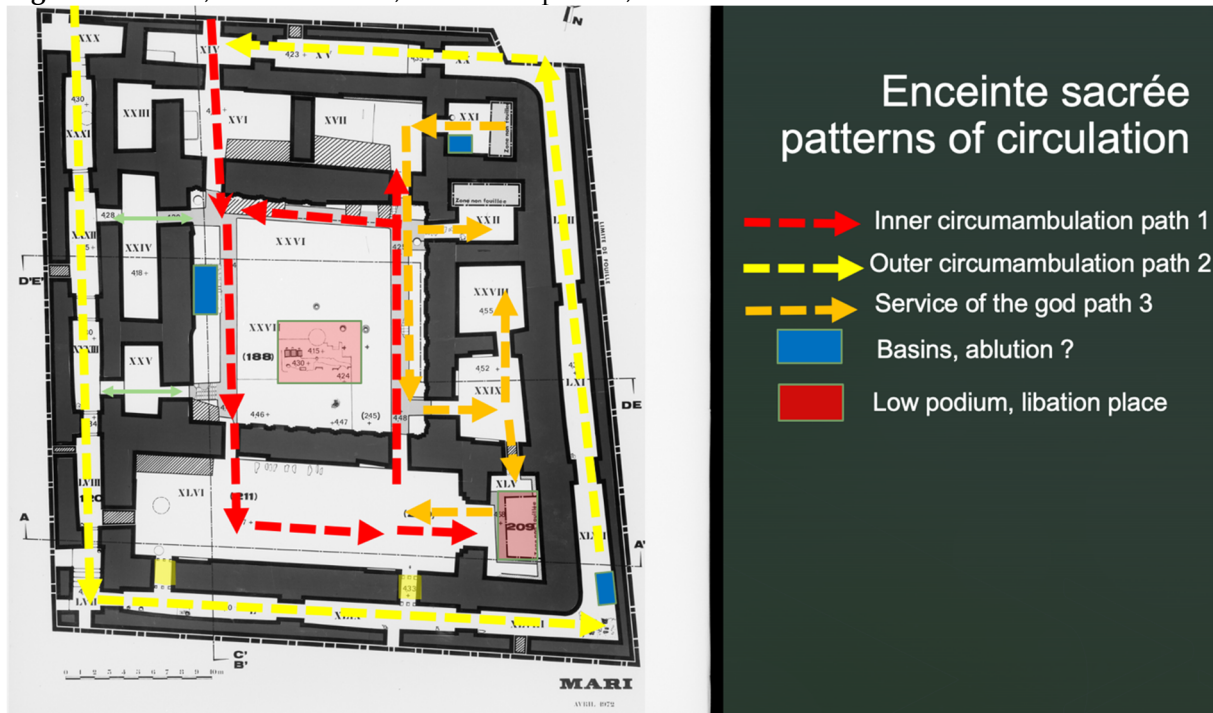
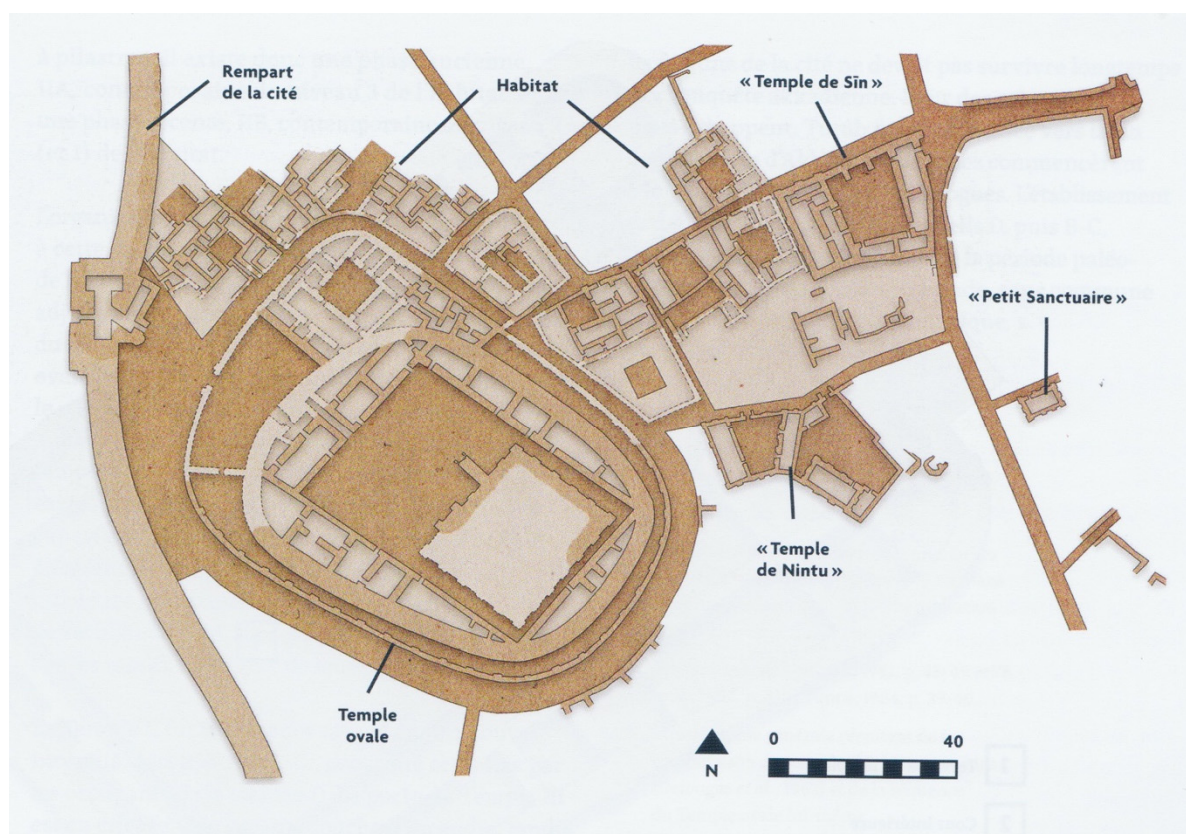


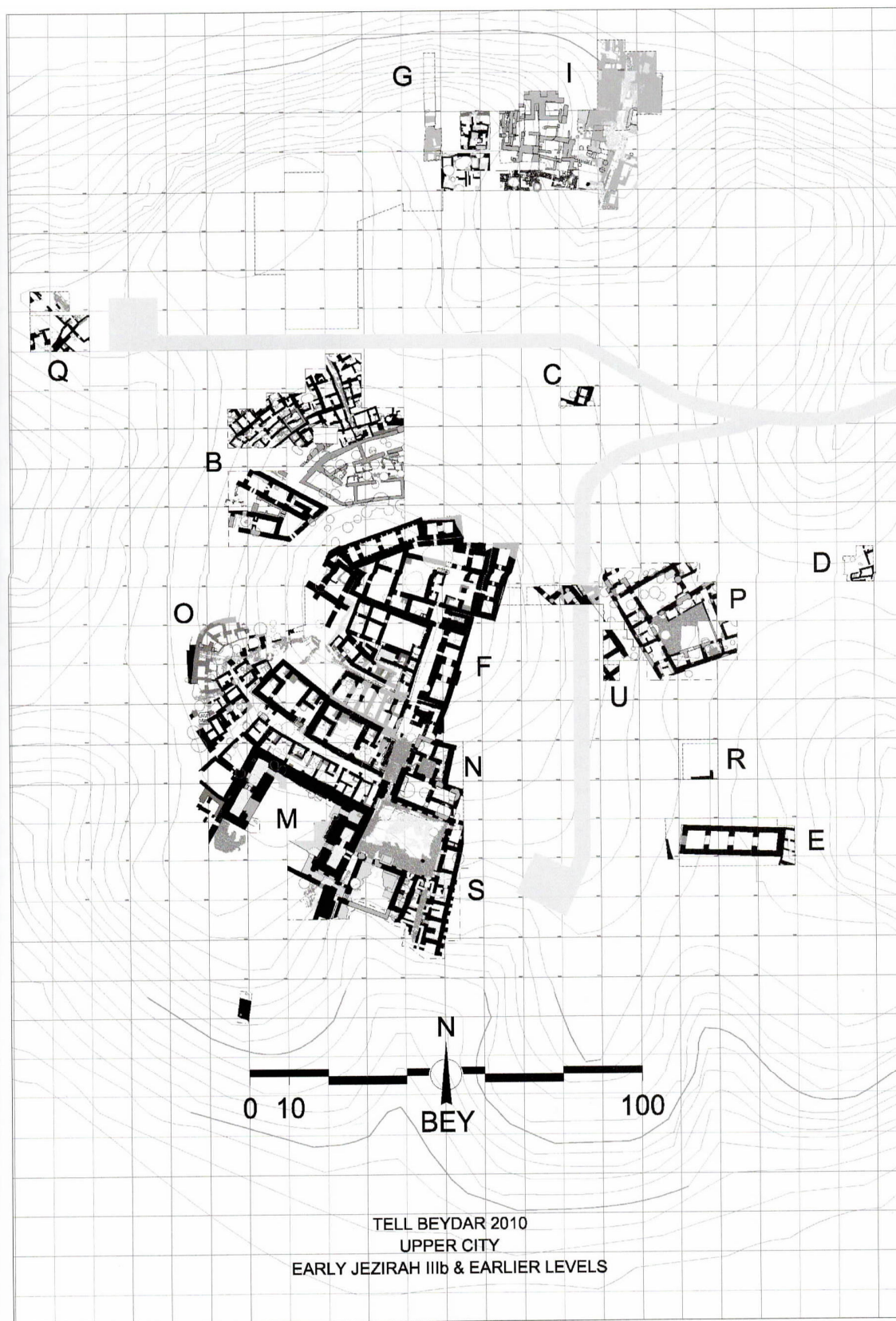
Figure S18: Mari, enceinte sacrée, circulation pattern, Pascal Butterlin



**Figure S19:** The monumental center at Khafadgé, courtesy Philippe Quenet.

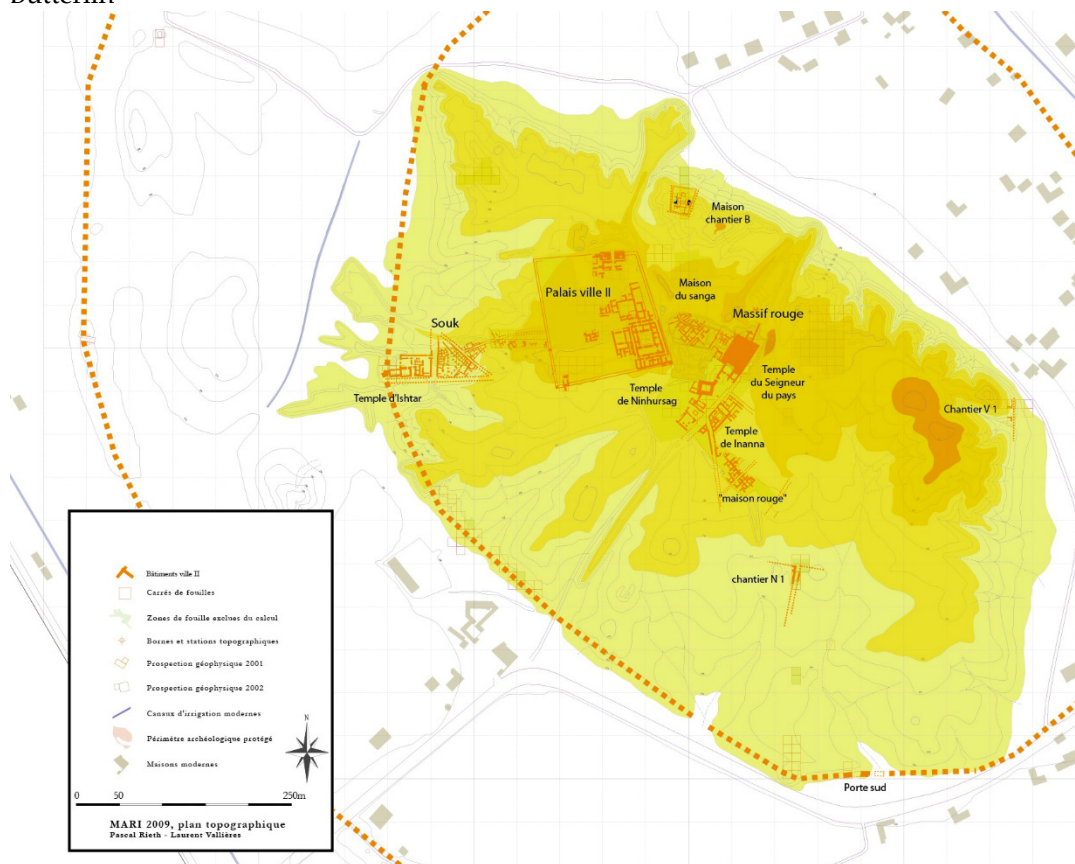


**Figure S20:** Tell Beydar, Nabada, EJ III b upper-city, courtesy Marc Lebeau.

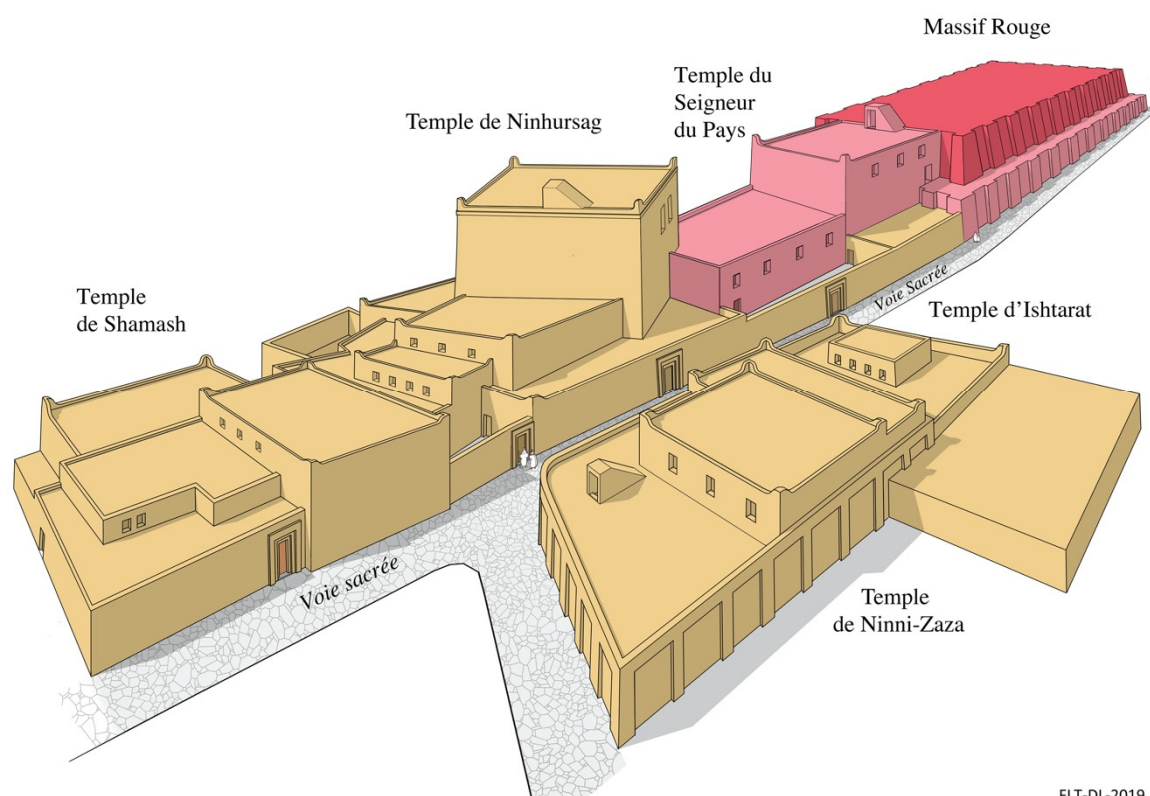




**Figure S21:** Mari, City II, monumental center, mission archéologique française de Mari, Pascal Butterlin



**Figure S22.** Mari, monumental center, reconstruction , mission archéologique française de Mari, drawing by Françoise Laroche Tronecker and Didier Laroche.



FLT-DL-2019