

Article

A Parametric Approach for Optimizing Design Solutions in Urban Regeneration and Reshaping: An Application to a District Block in Bologna, Italy

Cecilia Mazzoli ^{1,*}, Dimitra Papadaki ²  and Annarita Ferrante ¹ 

¹ DA—Department of Architecture, University of Bologna, 40136 Bologna, Italy; annarita.ferrante@unibo.it

² Group of Building Environmental Studies, Physics Department, University of Athens, 15784 Athens, Greece; dpapadaki@phys.uoa.gr

* Correspondence: cecilia.mazzoli@unibo.it

Abstract: This paper addresses the deep renovation and enhancement of energy efficiency in existing urban areas, aiming to transform them into zero energy districts, utilizing renewable sources. This transformative process is essential to align with contemporary models for new buildings and to elevate existing structures to meet environmental housing standards mandated by current regulations. The proposed densification strategy is motivated by the necessity to augment the real estate value and enhance the architectural and performance quality of the existing building stock, all while minimizing additional land occupation. Its efficacy has been rigorously tested and demonstrated within the European Horizon 2020 project “ABRACADABRA”. The key actions advocated for in this approach revolve around the incorporation of renewable energies, volumetric expansion, and completion volumes (urban infill), within the Positive Energy District. The validation of this process occurs on a district scale in a social housing urban block located in Bologna (Italy), with currently poor environmental performance. A multi-criteria analysis was employed to examine the architectural, climatic, and energy context. The meta-design phase successfully attained the energy and economic targets set by the project and by local and European regulations settings, offering an optimized design solutions for reshaping the built environment.

Keywords: urban densification; volumetric additions; urban infill; positive energy district; Bologna; parametric design tools; multi-criteria analysis



Citation: Mazzoli, C.; Papadaki, D.; Ferrante, A. A Parametric Approach for Optimizing Design Solutions in Urban Regeneration and Reshaping: An Application to a District Block in Bologna, Italy. *Buildings* **2023**, *13*, 3123. <https://doi.org/10.3390/buildings13123123>

Academic Editors: Peng Du and Rahman Azari

Received: 7 November 2023

Revised: 5 December 2023

Accepted: 15 December 2023

Published: 16 December 2023



Copyright: © 2023 by the authors. Licensee MDPI, Basel, Switzerland. This article is an open access article distributed under the terms and conditions of the Creative Commons Attribution (CC BY) license (<https://creativecommons.org/licenses/by/4.0/>).

1. Introduction

One of the most obvious phenomena manifested that can be seen in the medium- sized and large cities of our time is urban sprawl. The phenomenon of urban sprawl describes a certain peculiar settlement processes, that takes place mainly in the peripheral areas of consolidated urban cores. These processes are the result of a lack of foresight in spatial planning, which leads to high land consumption and considerable costs for society, both in environmental and economic social terms.

This formless urban growth, in other words periphery, peri-urban, agglomeration, urban fog, exurbia (i.e., diffuse city, in which the size of the city has exceeded the recognizable measure), as Ingersoll defines “urban sprawl”, occurs in the peripheral areas of cities, and combines uncontrolled urban expansion in these areas with the phenomenon of low population density [1].

After the Second World War, the uncontrolled expansion of cities in Europe was initially curbed due to a new awareness of the historical building fabric damaged by the war, and consolidated but incisive spatially. At the same time, large housing estates were planned and built in the major cities. The European diffusion processes are of various kinds: economic, demographic, housing policy, and infrastructural. Nevertheless, two aspects can be assumed. Firstly, that agricultural areas on the outskirts of cities are subject to diffusion,

due to their low cost, compared to already urbanized areas. Secondly, the decrease in the attractiveness of urban centres in contrast to the increase in the attractiveness of rural areas.

There is a clear need for the development of policies and strategies on land consumption and fragmentation of urban areas, that will lead to altered ecological balances, with less impact on local flora and fauna. Nevertheless, with the New Green Deal [2], the European Union (EU) is carefully addressing issues of decarbonization, energy sustainability, and the use of renewable energy sources [3,4] through processes of urban regeneration, as well as the realization of new buildings. However, diffuse processes must be integrated into a legal framework that regulates them according to sustainable planning methods.

In European policy, the role of the city and the management of its resources are key elements for future sustainable growth. Urban regeneration is a coordinated set of actions not only for urban planning and construction, but also for the development of the social, productive, and cultural fabric of urban areas, with a view to environmental sustainability and strengthening the resilience of cities.

In terms of land use, agricultural use and open spaces should be minimized as much as possible. Nevertheless, there is a need for new housing units, but if land is withdrawn, it should be ensured that this can be compensated for elsewhere. For example, unused land could be recultivated or denaturalized so that it can once again provide the ecosystem services of unsealed soils [5].

This process also introduces the principles of recycling and the circular economy, which are already expressed in the Europe 2020 strategy [6], into urban and spatial planning, with the ultimate aim of decoupling urban development from the consumption of land resources [7]. The concept of circular economy aims to transform current production and consumption patterns that place a significant burden on our planet and its environmental capacity [8]. With the Communication Roadmap to a Resource-Efficient Europe [5,9], the European Commission (EC) has determined that European policies should take into account the direct and indirect impact of land use change by setting the ambitious goal of ‘zero net land take’ by 2050 [5,10]. Comprehensive interventions in buildings, in line with the objectives of the European directives, avoid further land use and can initiate urban and social regeneration processes towards future sustainable cities [11].

Among the various instruments promoted for the regeneration of urban fabric is urban densification, which is seen as a process of selective intervention in pre-existing urban fabrics. These include different construction strategies, such as smart growth, the formation of communities of a manageable size, and the careful development of social needs. This positively influences the containment of the use of green spaces and the expansion of built-up areas at the expense of agricultural areas. A compact city with a high population density is the best answer to the need to accommodate growing population masses. Although Europe’s population growth is declining, other forces may be driving the growth in housing demand. One of the causes is the increase in smaller families, a phenomenon that can be attributed to various reasons, including changing lifestyles and an ageing population, which will keep demand for housing active. In addition, urbanisation is increasing significantly; 75% of Europeans already live in or near cities [12].

The challenge for architects and urban planners is to develop strategies for the regulating the expansion of large urban agglomerations, considering land use and housing density.

2. Strategy and Method of Intervention

2.1. Urban Densification Strategy

The harmonization of the existing urban fabric and strategically planned and selective expansion of the built heritage can reduce land consumption and the overall environmental footprint [13]. This helps to initiate a positive process of sustainable urban development, especially in cities that are currently characterized by fragmentation and dispersion settlement.

The opportunities associated with urban densification include: the use of all interior spaces of the built-up city, the minimization of further land consumption, the uncontrolled expansion and fragmentation of landscapes, the enhancement of permeable areas, and the

intensity of cultural relationships and developments. Potential constraints to densification, on the other hand, include mobility congestion, the vertical development of buildings, reduction in the size of housing units, and reduction in the provision of standards [7]. Moreover, challenges inherent in urban densification, include substantial financial investments, private property issues, and structural limitations of buildings, may impede their execution in urban areas. This is true even as they become integrated into ongoing urban planning policies. Consequently, it becomes imperative to deepen our comprehension of the environmental benefits stemming from physical interventions, emphasizing the positive outcomes over associated costs [14].

The adoption of a holistic approach that synergistically considers the dimensions of environment, society, and economy is of crucial importance for the process of building densification [15]. If high settlement density is desirable as a contribution to sustainable urban development, the question arises: what density is realistically sustainable? This paper aims to confirm that it is possible to design sustainable urban densification as a participatory tool to achieve a new energy and social balance. The identification of precise indicators will help clarify the potential of the proposed planning instruments. Densification processes in the consolidated and compact city will have a greater positive impact when associated with adequate public transportation infrastructures, or in derelict abandoned land close to the city's existing spaces and services. To this end, it is necessary to verify the possible adoption of multi-scalar well-defined solutions, which are more easily and physically connected to the centre areas of the city. From this perspective, the case study investigated in this paper is indeed part of the most consolidated urban areas of the first expansion of the city of Bologna and, therefore, very well-connected and linked to the existing services of the urban community.

2.2. The ABRACADABRA Project

The EU's challenge on energy efficiency in buildings is mainly about energy-efficient renovation and investment in existing building stock. Yet, there is a clear lack of investment in this sector and, particularly, the housing market. This is since high upfront investments are required and characterized by a high degree of risk, with potentially limited return on investment. The housing stock in the EU comprises around 200 million units, accounting for around 27% of energy consumption in the EU. Three quarters of today's buildings stock, including residential stock, is expected to remain in operation until 2050. To date, only 0.4 to 1.2% of existing buildings in the EU are renovated each year [16–18].

Under the Horizon 2020 European funding program, the project “ABRACADABRA—Assistant Buildings' addition to Retrofit, Adopt, Cure And Develop the Actual Buildings up to zeRo energy, Activating a market for deep renovation”, under grant agreement No. 696126 [19], promotes the implementation of measures to increase urban density by adding habitable space to existing buildings. This extra space, through the financial benefits that can be generated, can help finance the renovation of the entire building. This proves to be significant, since the cost–benefit assessments of retrofitting actions show excessive payback times, creating a strong and generalized lack of confidence by investors and final users [20]. Moreover, this type of intervention is a useful tool to reshape the urban landscape or transform former non-residential buildings into new housing units. The ABRACADABRA project is based on the assumption that a substantial increase in the property value of existing buildings can play a key role. Indeed, the project has demonstrated the attractiveness of redevelopment based on volumetric additions and the use of renewable energy sources, called Add-ons and Renewable Energy Sources (AdoRES). Volumetric add-ons can be meant as one or more building units, such as side facades, roof extensions, or even new building constructions, that “assist” existing buildings in achieving the near-zero energy goal. This strategy, if adopted at the urban scale, can lead to the implementation of a punctual building densification policy within still transformable areas of cities. In this context, the goal of the project is to induce legislative and market change, accelerating the revolution toward nZEB targets [20].

2.3. Legislative Framework

The European Directive 2018/2001/EU [4] promotes the use of energy from renewable sources and requires that 32% of the EU's energy consumption will be covered by renewable energy sources by 2030. Furthermore, the EU has set itself the target of reducing net greenhouse gas emissions by at least 55% by 2030 compared to 1990 levels [2]. On December 2019, the EU heads of state and government decided to make the EU climate-neutral by 2050 in line with the Paris Agreement [21,22]. In the field of local spatial planning for the Emilia-Romagna region, where the case study of this research work is located, regional law no. 24/2020 stands out, which introduced the new general urban plan (*PUG—Piano Urbanistico Generale*) [23]. The general planning instrument includes environmental resilience, support for the attractiveness of the city and the supply of skilled labour, and the need to ensure habitability and inclusion.

2.4. Positive Energy District (PED)

In Italy, the Ministerial Decree of 16/09/2020 [24] introduces the concept of energy communities on a trial basis, and regulates the implementation of their incentive system. Its focus is on the transition to a more sustainable and decentralized energy system, based on the use of renewable energy and the active participation of citizens.

With the three-year implementation plan 2022–2024 [25] of the Regional Energy Plan 2030 [26], the Emilia-Romagna region has adopted most of the recent measures taken by the Italian government at EU level. These measures have made the climate and energy targets progressively more ambitious, with the aim of increasing energy efficiency and covering an increasing share of consumption with renewable energy. In this context, the new Regional Law no. 5/2022 [27] also establishes the obligation to support the dissemination of renewable energy communities, which is definitively regulated by Legislative Decree no. 199 of 08.11.2021 [28], implementing the EU Renewable Energy Directive 2018/2001 [4].

The common goal of these new models of energy production and consumption is to make a tangible contribution to complete decarbonization, to further exploit the potential of renewable energy sources. This will promote an energy system based on proximity, decentralization, and interconnection, also through a more active role of end customers [29].

2.5. Urban Infill

Soft densification through “urban infill” design interventions is a strategy that can potentially be replicated extensively. This can be performed through a systemic approach, functional to the physical characteristics of the urban void, local needs, and contextual and case-by-case strategic requirements. Urban infills are an effective mode of densification for achieving a compact city, which is a prerequisite for sustainable city development. Architectural infill exhibits significant figurative variability, particularly in response to the morphology of the intervention area, effectively resolving the spatial dynamics. Within the dense urban structure, marked by intensive or semi-intensive buildings, specific void patterns recur. This categorization allows us to delineate five potential infill techniques: expanding and constructing a new building volume, adding a volume adjacent to an existing structure, inserting between blind facades, elevating structures and, ultimately, demolishing and reclaiming vacant areas [30].

The analysis of several recent projects in Europe based on the application of a densification strategy, also by means of urban infill, has made it possible to identify some common characteristics and design choices aligned with the requirements of the various directives on limiting land use, environmental protection, and the maximization of renewable energy use.

Urban sprawl results from high demand for new homes and limited city land. Densification is a recognized solution, but researchers face challenges determining city-wide densification potential. A 2021 study in Tanta, Egypt, focused on densification as a strategy to combat urban sprawl, proving its effectiveness in addressing issues like agricultural land loss. The research not only controlled urban growth, but also fostered sustainable

communities in developing countries. Successful densification relies on seamless integration of city planning, regulations, engineering, and social and economic aspects. Using an analytical hierarchy process, the study prioritizes densification sites based on sustainability parameters. Results showed potential for a 428% population increase in Tanta by 2027, while preserving 53% of agricultural land under current regulations [31]. The rise in the global urban population has generated an increasing need for additional residential space, leading to various adverse effects, including accelerated urbanization, urban sprawl, and elevated carbon footprints. In 2019, a study in Vienna delved into the potential of urban densification to counteract heat island effects and enhance outdoor thermal conditions. The study used simulations during hot summers to analyse the urban climate before and after densification using modelling tools. The results showed that adding vertical extensions to existing buildings had a significant solar shielding effect, lowering temperatures and enhancing thermal conditions in shaded urban areas [14]. Morphological changes, demographic shifts, and the deployment of renewable energy systems significantly influence the carbon performance of a precinct. In a 2020 study by Huang et al., an integrated carbon assessment model was developed to encompass overall precinct carbon emissions and the carbon offset derived from precinct-scale renewable energy harvesting. The results of the scenario analysis revealed that redeveloping buildings with higher energy efficiency ratings and increasing the penetration of renewable energy can have a lasting positive impact on the carbon performance of urban precincts. The analysis emphasizes the importance of embodied carbon in the total carbon footprint and the carbon reduction potential of a precinct during densification [32].

While there has been considerable research on urban densification planning to address environmental impacts, land use, and the challenges of decarbonization amidst population growth, there is a notable gap in research focused on densification strategies for existing urban areas also combining energy and financial aspects. Specifically, there is limited exploration of strategies that simultaneously consider deep renovation and improved energy efficiency through renewable sources, with the goal of transforming these areas into zero-energy districts. This paper aims to address this gap by proposing a densification strategy motivated by the need to increase real estate value and improve the architectural and performance quality of existing buildings, all while minimizing additional land occupation and promoting energy efficiency and renewable energy production.

3. Analysis of the Case Study

3.1. Research Methodology

This paper focuses on a specific building block located in the San Donato district in Bologna. The analysis employs a multi-criteria approach to identify socio-cultural obstacles, energy performance deficiencies, and economic barriers. These factors are crucial considerations for designing a comprehensive urban reshape and energy efficiency intervention at an urban scale. The multi-criteria approach, supported by specific digital tools, allowed us to balance all the above-mentioned factors and to select the most successful solution according to the project's target, linked to local needs and regulations. These targets are social inclusion and accessibility, enhancement of green spaces, energy efficiency measures and RES installations, reduction of payback times and, hence, profit-making.

Based on the design concept of urban reshaping through infills and volumetric additions blocks, several intervention scenarios were proposed. The research method adopted pursued the following phases:

- (i) Analysis of the architectural and social context, in order to identify the critical points in terms of accessibility to the block, connection with the road system, availability of green areas, presence of buildings with historical documentary value.
- (ii) Creation of different intervention scenarios (Concept #0–COURTYARD, Concept #1, Concept #2, and Concept #3).
- (iii) For each intervention scenario, a climatic and environmental analysis was conducted using digital simulations with the *LadyBug–Grasshopper* software. This was aimed

- at assessing the climate parameters necessary for determining potential blocks to be demolished, with the goal of enhancing the environmental characteristics of the blocks.
- (iv) For each intervention scenario, an energy analysis was developed with *Dragonfly–Grasshopper* software. This was aimed at calculating the energy needs and consumption of different volumetric assumptions for urban infill interventions.
 - (v) Comparison of the different scenarios and selection of the optimal layout of buildings, balancing all the parameters calculated (for the climatic and environmental analysis: SunPath, Shadow Range, Universal Thermal Climate Index (UTCI), Direct Sun Hour Analysis, Incident Radiation, and Solar Envelope; for the energy analysis: End Use Intensity (EUI)).
 - (vi) Verification of the project targets in terms of profit from the investment before and after renovation.
 - (vii) Verification of the available surfaces for renewable energy sources (photovoltaic panels on roof and facade) to accomplish the energy balance of the whole settlement by and through the final reshaping of the urban blocks.

3.2. Multi-Scalar and Multi-Criteria Approach

As a first step, a multi-scalar analysis was carried out for all the aspects of the built environment at the urban scale, the block building scale, and at the level of the individual buildings. Given the multiple aspects to be considered in the energy and urban regeneration, the adopted approach has considered the evaluation of multiple criteria, based on the collection and analysis of data related to the environmental, energy and social characteristics of the site. From this perspective, the analysis aimed at “measuring to optimize” the urban context and the climatic context of the city in relation to the environmental characters of the blocks, through environmental analysis using parametric analysis software, as well as the performance aspects of the buildings, through district-scale energy analyses using parametric software.

Given the complexity of these criteria and the multiple indicators embedded in them, the multi-criteria analysis [33] implemented here has necessarily been divided in different steps (see Section 3.3, Section 3.4, Section 3.5), then analysed and compared to feed the next design steps in an optimized manner. This process has been designed to exploit more detailed parametric digital tools and explore various scenarios for an optimized deep renovation considering both volumes and related real estate values, as well as energy performance. In this framework, the optimized design solutions for the reshaped building blocks are those that provide the maximum increase in terms of real estate value while guaranteeing the energy balance and self-sufficiency.

3.3. Analysis of the Architectural and Social Context

The case study is an urban block in the San Donato district in Bologna, located in the North-East part of the city. San Donato is one of the city’s most diverse residential neighbourhoods, due to the age variability and the cultural backgrounds of the residents. This district stands as one of the city’s strategic points regarding vehicular mobility, as it has several major roadways and is served by metropolitan rail service (Figure 1).

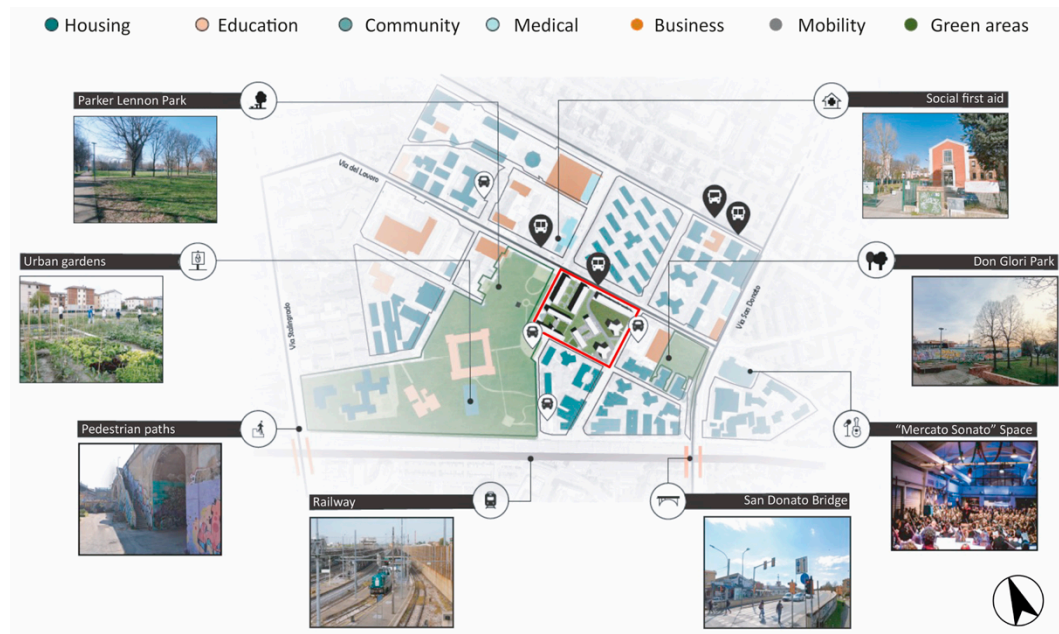

Figure 1. Graphical representation of the different mixed uses in the area, main mobility infrastructures, and green areas. (© 2023, C. Mazzoli after Q. Palazzo and P. Dabbicco).

Nevertheless, one of the most significant concentrations of public housing exists in this district. Nearly 50% of the housing lacks adequate parking spaces. The area also experiences high population density, reaching up to 142 inhabitants per hectare, resulting in increased traffic, heightened demand for parking, elevated noise pollution, and a limited availability of communal facilities.

The green spaces in the San Donato district are primarily dedicated to agriculture. However, there is a recent trend of reclaiming areas for gardens and small parks within the closely woven grid of buildings near the historical centre (see Figure 2). In general, while the amount of green space is considered insufficient, there has been significant redevelopment in recent years.

After a district-scale analysis, the study focused on the specific urban block located in the eastern part of the neighbourhood, closer to the city centre and to the railway.

The social perspective was registered by collecting advice from residents through ethnographic research and interviews. This information was crucial for understanding the residents' needs and, thus, supporting the decision-making process in terms of selection of buildings to be demolished (such as buildings 8 and 9, that were indicated as inadequate for spatial characteristics, functionalities, and indoor comfort levels from residents).

The urban block takes on a rectangular configuration and comprises a total of nine buildings, as illustrated in Figure 3. Seven of these buildings align in a row. The structures include: two "Popolari" blocks (blocks 1 and 2); two "Popolarissime" blocks (blocks 3 and 4); two buildings of lower height than the others, oriented at an incline to the street axes (blocks 8 and 9, proposed for demolition both for the ethnographic analysis and for their negative climatic impact due to the undesired projection of shadows within the courtyard and towards the existing buildings); two tower buildings with a distinctive "Y"-shaped structure (blocks 6 and 7); and a single in-line building (block 5) (Figure 4).

The urban block is bisected by a private driveway, featuring a limited number of condominium parking spaces. This roadway, along with a handful of parking spaces within the inner courtyards, defines the internal pathways, which are degraded and poorly interconnected due to the enclosure of the outdoor spaces of the tower condominiums.

The block is bounded to the west by a one-way street and to the east by major high-traffic streets. Immediately next to the lot is the Parker-Lennon garden which, however, does not appear to have pedestrian connection with the block.



Figure 2. Graphical representation of the pedestrian and cyclable paths, and the most important private and private green areas. (© 2023, C. Mazzoli after Q. Palazzo and P. Dabbicco).



Figure 3. Aerial view of the project block. (© 2023, C. Mazzoli).

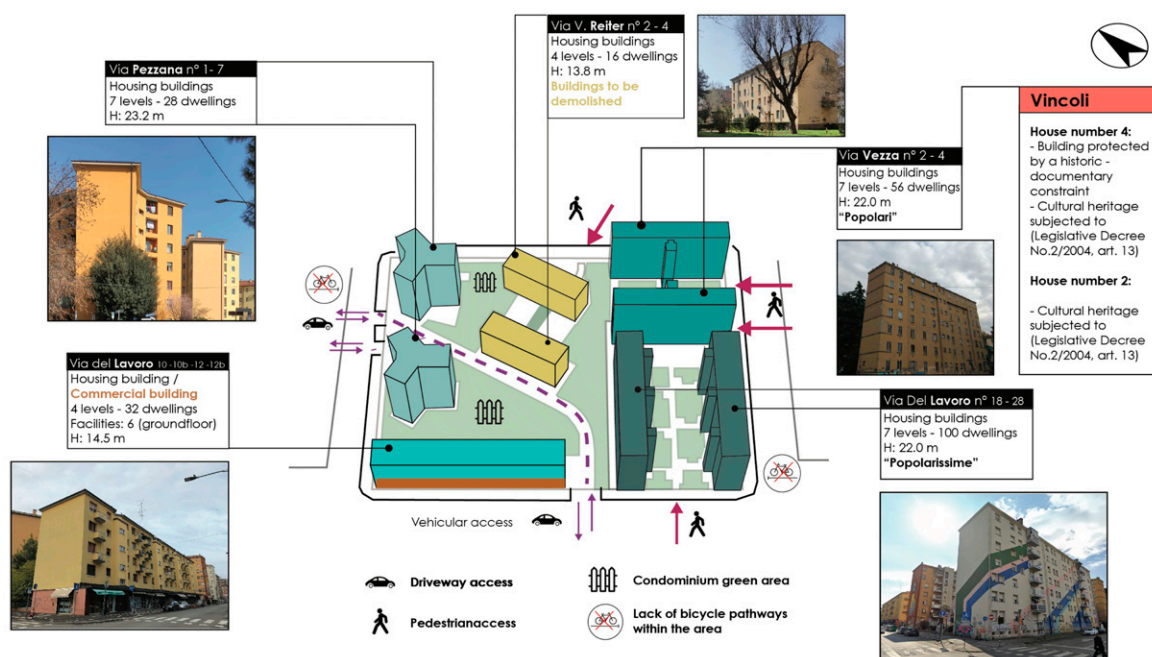

Figure 4. Graphical representation of the nine buildings located in the block. (© 2023, C. Mazzoli after Q. Palazzo and P. Dabbicco).

The construction of the parcel is part of a plan of social housing interventions in the first half of the 20th century, aimed at the weakest classes of the population, with reference to the families of recent immigration in the early post-war period.

The first buildings were constructed in the immediate first post-war period: among them are the "Popolarissime", designed between 1934–1936, and the "Popolari", whose name derived from their social housing function (in Italian, "popolare" alludes to the working class for whom these buildings were built). All these buildings were constructed as an emergency plan by social housing institutions to provide housing for families evicted from the historic centre districts demolished during the fascist era. They are buildings with a reinforced concrete frame structure and brick envelope. The current thermal and structural performance of these buildings is very poor and, therefore, deep renovation interventions to improve performance and to modify some distributional characteristics of the interior spaces are necessary to improve living comfort. The entire built-up area of the block, although it emerged in successive phases over a twenty-year period, shows a clear rationalist imprint regarding its architectural style. Rationalism imparts a design approach characterized by rows of buildings aligned perpendicular to the streets, featuring a uniform orientation. The structures are evenly spaced at a minimum distance to prevent shading between buildings, ensuring that facades receive ample sunlight, even during the winter solstice.

From the naturalistic point of view, the subdivision is characterized by various types of trees, including tall trees (common plane, Atlas cedar, oak, and beech), which provide excellent shading, protection against solar radiation, and low maintenance costs given their performance.

Today, such building stock, built more than fifty years ago, is inadequate with respect to current energy and seismic safety requirements and regulations, and therefore requires consolidation and energy efficiency interventions. Furthermore, considering demographic indicators, there is a necessity for interventions aimed at enhancing accessibility and eliminating architectural barriers within the residential infrastructure.

The energy simulations were developed through the use of digital parametric tools, namely *Dragonfly-Grasshopper*, which uses the simulation platform *URBANopt SDK (Urban Renewable Building And Neighborhood optimization) 0.10.0*, based on *EnergyPlus 23.2.0* and

OpenStudio 3.7.0 SDK, aimed at district-scale thermal and electrical analysis for energy modelling of urban communities and districts. The results from these energy simulations prove the significant deviation of the buildings from the energy requirements standards of a nZEB, mostly due to high insulation deficits in the envelopes and oldness of energy installations accompanied by visible degradation of materials. These characteristics are combined with the complexity of the buildings due to the varying orientations, heights, the almost total absence of adequate interior lighting and a parallel deficient passive shading. In general, the transparent elements of a building play a key role in the heat and mass transfer control, and also in natural light penetration, sound insulation, the thermal and visual comfort of the occupants and their health, and the improvement of aesthetic features [34]. Therefore, the bioclimatic design of this urban block emerges as a particularly challenging project, which the present research endeavours to address. This includes the incorporation of volumetric additions while mitigating potential adverse impacts.

3.4. Climatic and Environmental Analysis

According to the Köppen–Geiger classification, the climate of the city of Bologna falls into the “Warm summer temperate climate” range, typical of the low-altitude areas of northern Italy. In the cool season, temperatures range from 0 °C to 22 °C. The mild seasons range from 8 °C to 25 °C, and during them, about 60% of the daytime hours require no air conditioning. For this reason, passive strategies of ventilation, lighting, and reduction of solar loads in indoor spaces were incorporated in the development of this project. Throughout the summer season, the temperature ranges from 16 °C to 36 °C, with daytime temperatures mostly surpassing 25 °C and experiencing high solar radiation levels. Hence, it is imperative to implement effective external shading in the project, strategically designed to reduce solar exposure on glazed facades and alleviate the workload on air conditioning systems. Examination of climatic data for the Bologna area indicates a robust average of daily sunshine hours, exceeding 12.2; however, this can vary based on the prevalence of cloudy days. The incorporation of site-specific climatic data, combined with a thorough contextual analysis, has proven essential in identifying the optimal environmental and climatic conditions for conducting climate simulations.

All simulations were carried out through the *LadyBug* plug-in of *Grasshopper* software, a parametric workspace within *Rhinoceros 8*, where the geometries then subject to the simulations are modelled. *Ladybug* provides a variety of interactive 2D and 3D climate graphics that support decision making during the early design stages through solar radiation studies, view analysis, and modelling of sunlight hours.

The fundamental concept guiding the design process revolves around the aspiration to establish a unified and expansive urban courtyard that mirrors the dimensions of a private block. This courtyard aims to be easily accessible to residents, incorporating green spaces and communal facilities. As a result, initial design decisions dictated the removal of centrally positioned blocks (blocks 8–9) arranged diagonally in relation to street directions. This choice was driven by the blocks’ varying heights and orientations compared to surrounding structures, introducing environmental challenges that make bioclimatic design notably complex and hindering the creation of a usable outdoor area. Additionally, it was deemed necessary to demolish the stairwells of blocks 1–2 (Figure 5) due to their structural inadequacy, as they were constructed later than the buildings themselves. This decision contributes to a proposed demolition area totalling 593 m².

Due to the parametric process, it was possible to carry out the simulations on different input geometries by considering not only the existing state of the site, but also assumptions of demolitions and new infill volumes. These were useful to map and compare different morphologies of the block. Specifically, the solar path was initially analysed through the *SunPath* parameter analysis during the summer season and in two different hours (10 am and 3 pm). Furthermore, the Universal Thermal Climate Index (UTCI) was assessed in terms of Temperature UTCI (measured in perceived temperature in °C) and Comfort UTCI (measured in UTCI thermal stress); this allowed us to obtain insights into the interior

microclimate of the urban block and define strategies for open spaces (Figure 6). Other parameters linked to the solar impact on the buildings have been assessed, such as the Shadow Range in summer and winter season and the yearly load (measured in percentage of daytime shadow) (Figure 7). Subsequently, the analysis of the Incident Radiation (measured in kWh/m²) was carried out on the facades of the volumes in summer and winter season (Figure 8), as well as the Direct Sun Hour analysis during summer in order to calculate the daily sun hours on the envelope of buildings (Figure 9). Through the analysis of all these parameters, combined also with the Solar Envelope study (Figure 9), it was possible to understand the spatial relationships between the buildings and to locate the surfaces with higher and lower illuminance criticality.

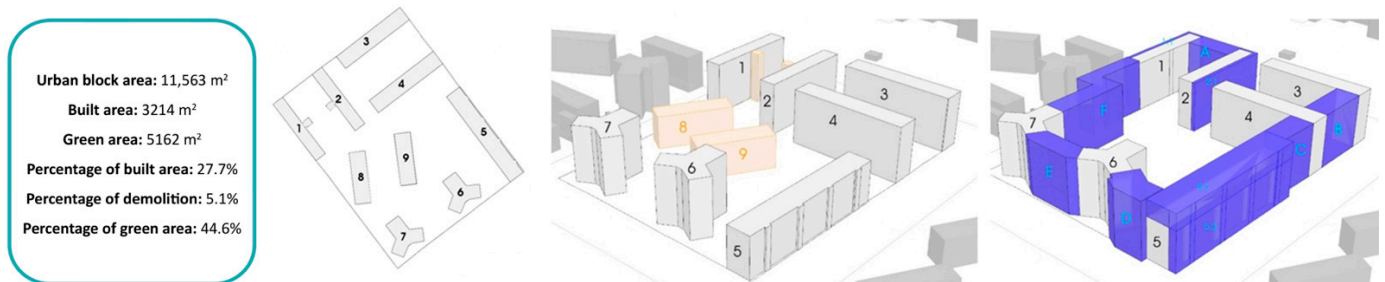
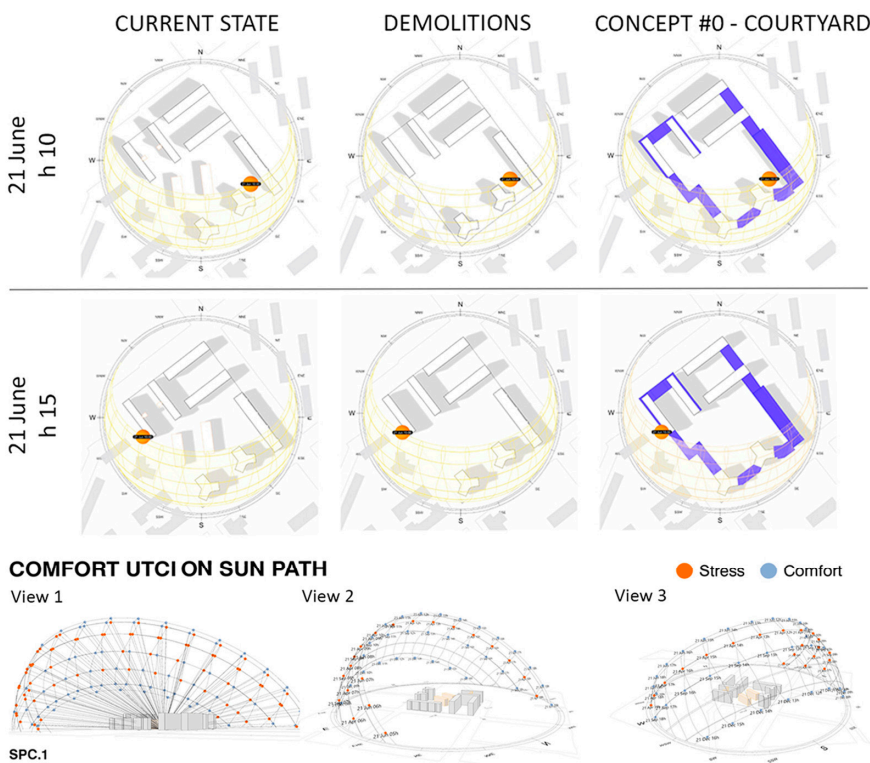

Figure 5. (From left to right) existing state plan of the lot under consideration; perspective axonometry of the existing lot showing demolitions (yellow blocks); perspective view of the urban block under study for scenario Concept #0–COURTYARD with new infill and add-ons blocks (in purple) (© 2023, C. Mazzoli after Q. Palazzo and P. Dabbicco).

SUN PATH



UTCI COMFORT ANALYSIS

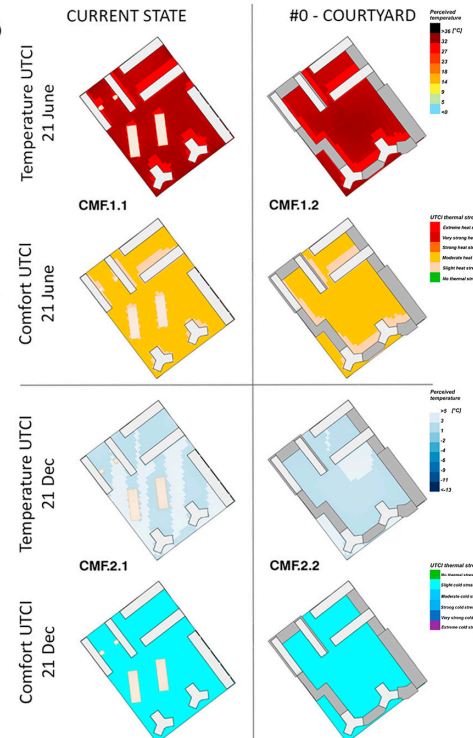

Figure 6. Abacus of the environmental simulations for the current state scenario and the Concept #0–COURTYARD scenario: SunPath and UTCI comfort analysis (© 2023, C. Mazzoli after Q. Palazzo and P. Dabbicco).

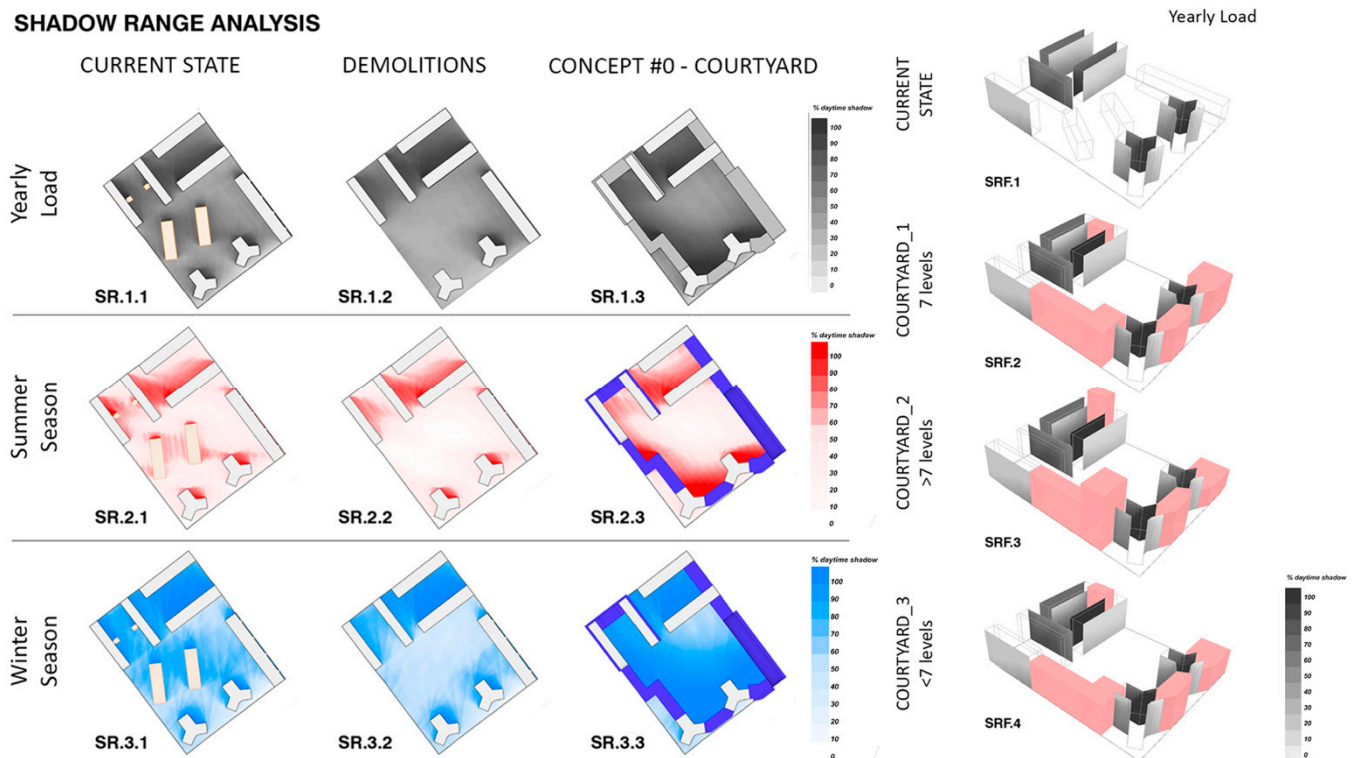

Figure 7. Abacus of the environmental simulations for the current state scenario and the Concept #0–COURTYARD scenario: Shadow Range analysis (© 2023, C. Mazzoli after Q. Palazzo and P. Dabbicco).

All the results obtained in the simulations were then collected in a comparison table and each heatmaps displayed in a general abacus of the environmental simulations (Figures 6–9).

Among the various values mapped, it is of particular interest for considerations on photovoltaic (PV) systems, the share of solar irradiance that invests the facades of the south front of the block: in fact, in the winter season, this value reaches higher peaks than in the roof. In addition, the presence of a full elevation on the south front would allow a significant gain of shading in the inner courtyard (+12%) by defining clearer areas of shade and light and, therefore, be more easily modulated by design (Figure 10).

In the local area, a PV system that is in the optimal tilt (35°) and climatic conditions can produce, for example, around 1200–1300 kWh per year per kWp of power while, when opting for flat PV, it is reduced to 1000–1050 kWh per year per kWp of power.

In particular, the Direct Sun Hour analysis and Incident Radiation analysis climate simulations provided useful data for the positioning and quantification of the PV systems envisioned as the main strategy of ABRACADABRA for self-supply of energy, as well as important indications on the most appropriate buildings to host on top Add-ons.

Roofs turn out to be the surfaces that receive the most solar radiation (in summer) with seasonal peak above 600 kWh/m^2 , thus are the most suitable for the installation of PV systems. Among the vertical surfaces, on the other hand, the south-facing facades are the most suitable for PV installation; in particular, the south front of the lot (5-6-7-D-E), which includes two blind facades, exceeds the values in the roofing in winter. In addition, passive shading systems have been provided on the south-east, south, and south-west fronts.

INCIDENT RADIATION ANALYSIS

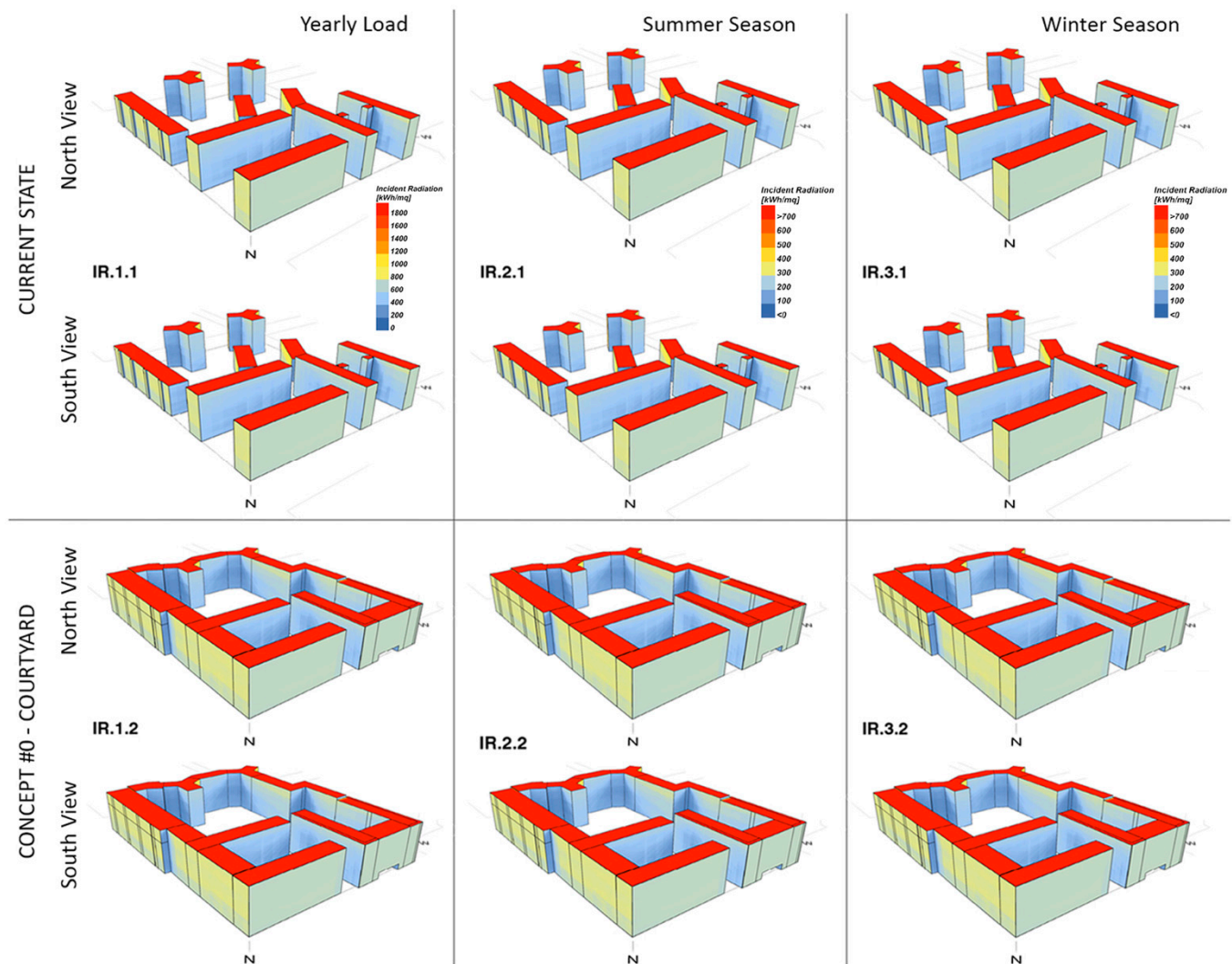

Figure 8. Abacus of the environmental simulations for the current state scenario and the Concept #0-COURTYARD scenario: Incident Radiation analysis (© 2023, C. Mazzoli after Q. Palazzo and P. Dabbicco).

3.5. Energy Analysis at the District Scale

The analysis phase was conducted via district-scale energy simulations carried out by *Dragonfly*, a plug-in of *Grasshopper* software, which, through the simulation platform *UR-BANopt*, allows the calculation of the energy use of an urban district energy model. These analyses made it possible to parametrically quantify the physical quantities of the geometries processed in the mentioned model, and especially to evaluate and estimate the energy needs and consumption of different volumetric assumptions for urban infill interventions.

In particular, the value of EUI, which is an energy efficiency indicator used in building design and/or construction, mainly used in the United States, was mapped in the different simulations to estimate the energy balance of the geometric models being simulated. The impacts of consumption for heating, cooling and lighting systems were analysed, representing the Monthly EUI and Monthly Energy Balance values (measured in kWh/m² for energy intensity).

DIRECT SUN HOUR ANALYSIS

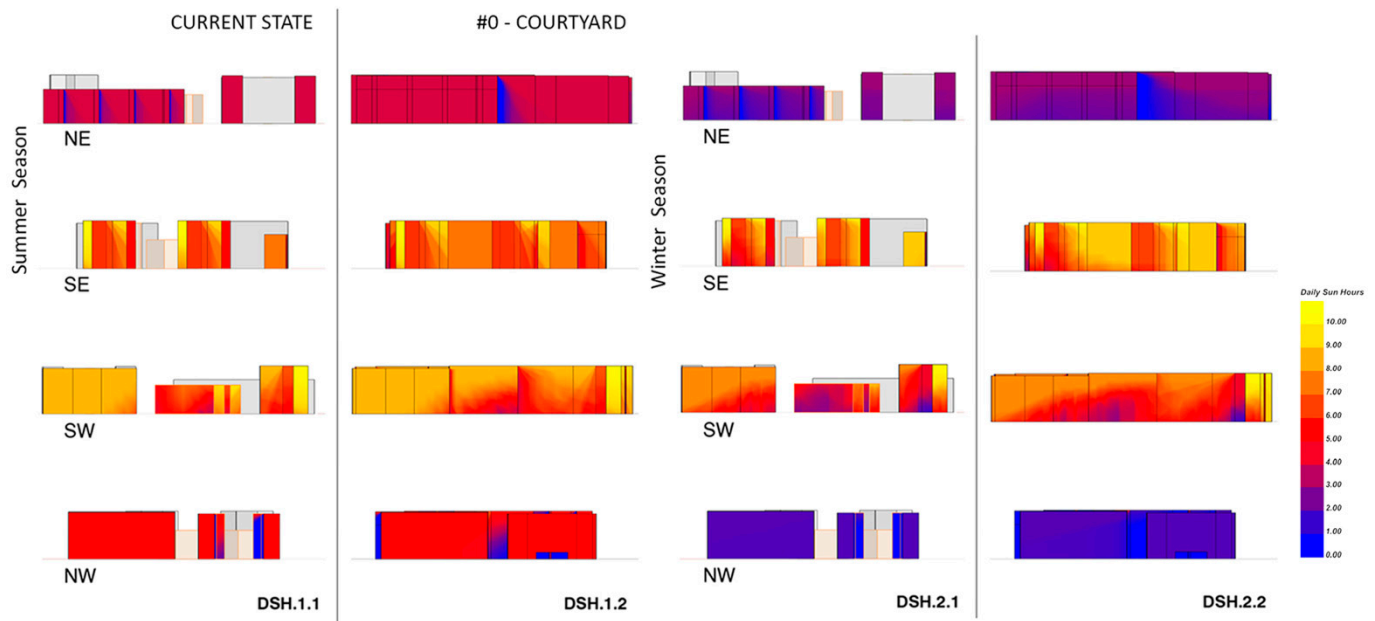

SOLAR ENVELOPE

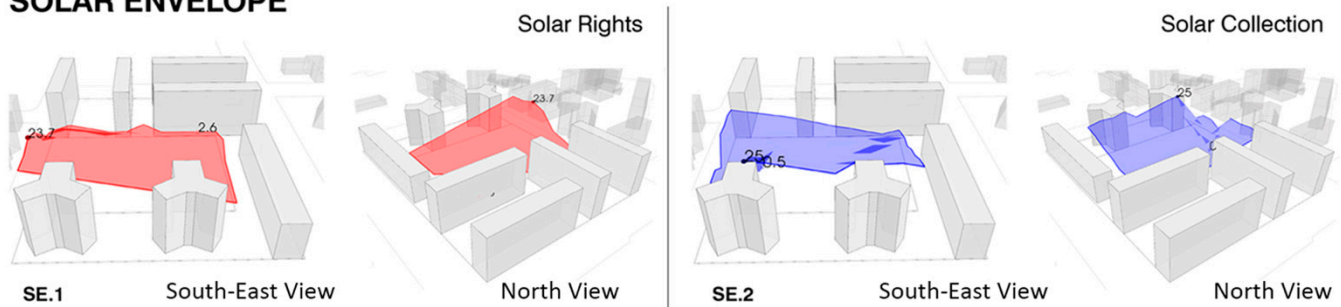

Figure 9. Abacus of the environmental simulations for the current state scenario and the Concept #0–COURTYARD scenario: Direct Sun Hour analysis and Solar Envelope analysis (© 2023, C. Mazzoli after Q. Palazzo and P. Dabbicco).

Calculation of heat demand was carried out based on a heat balance of the environment bounded by the building envelope. Knowing the efficiencies of the plant systems, the primary energy demand can be traced from the EUI value. To evaluate the results of the energy analyses, the values of EUI and more generally of energy consumption provided by the New Building Institute (NBI) [35] were taken into consideration. This provides average consumption targets for different types of building use, dividing them according to their climate class. In addition, NBI sets EUI standards for achieving nZEB. In this case, for the residential typology connoted as “Mid-rise Apartment” by ASHRAE programs (i.e., multi-family residential building higher than five stories), the achievement of the nZEB target occurs for an EUI of less than 75 kWh/m²/year. This value was considered as a numerical reference value for the comparison between the simulated design scenarios.

A precise “Construction set” was created within the *Dragonfly* algorithm to describe the architectural elements of the buildings and detail the energy model within the simulation algorithm. Each set contains the stratigraphy of the materials used, each characterized by its respective mechanical and physical properties (Figure 11).

SHADOW RANGE ANALYSIS

% daytime shadow

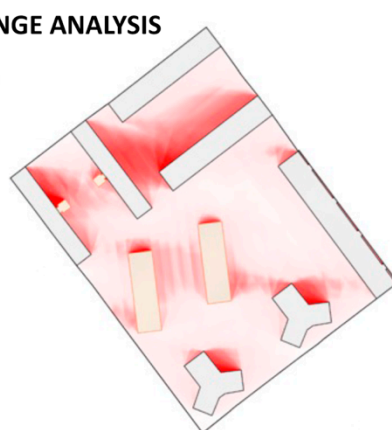
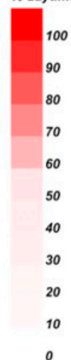

Current state - 21 June

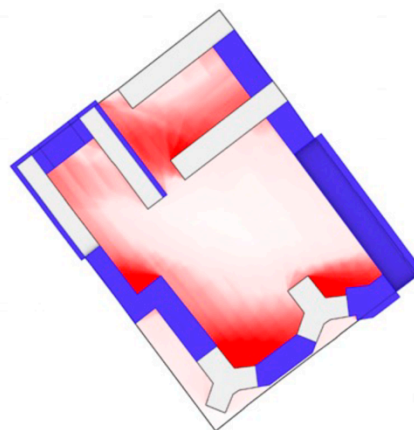

Concept #0 - COURTYARD - 21 June

INCIDENT RADIATION ANALYSIS

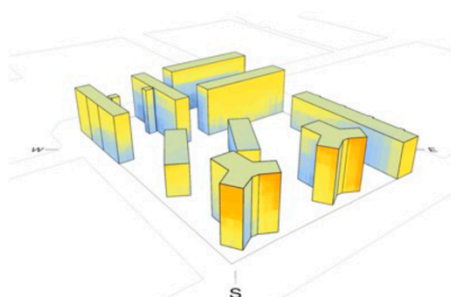
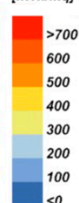
Incident Radiation
[kWh/mq]

Current state - 21 December

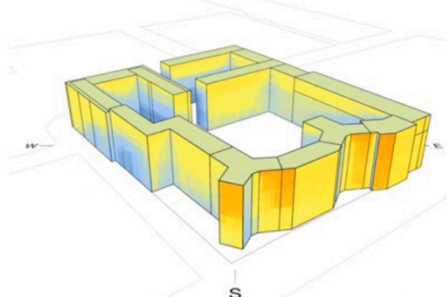

Concept #0 - COURTYARD - 21 December

Figure 10. Shadow Range Analysis (**top**) showing a significant gain in shading in the inner court (+12%), and Incident Radiation Analysis (**bottom**) showing that in the winter period the solar incidence is greater on the facades than on the roofs: (**left**) current state and (**right**) Concept #0–COURTYARD scenario. (© 2023, C. Mazzoli after Q. Palazzo and P. Dabbicco).

For the “Construction sets” referring to the current state, the construction stratigraphies of the buildings in the block was considered. In particular, the following traditional stratigraphies of residential construction built in Italy in the 1930s–1970s were evaluated: non-insulated facades in bricks (with a thermal transmittance U of $2.213 \text{ W/m}^2\text{K}$), hollow-core concrete roofs and ground-floors, and single-glazed windows.

Instead, stratigraphies referring to the deep renovation intervention mainly aimed at the energy refurbishment of the building envelope were associated with the energy simulations carried out on the assumptions of new volumes in the block. In particular, for the deep renovation of existing buildings, the following solutions were considered: the implementation of an External Thermal Insulation Composite System (ETICS) in rock wool (12 cm thick) for external walls, the integration of a thermal insulation layers in recycled textile fibres for roofs, and double/triple-glazed windows. For the new infill blocks, the envelope is considered as a ventilated facade composed of a X-Lam structure, high thermal insulation layer in rock wool and wood fibre (14 cm thick), a light metallic sub-structure for the creation of a micro-ventilated airspace (3 cm thick), and a dry finishing cladding system in ceramic (1 cm thick). The thermal transmittance of the envelope systems considered for these scenarios ranges from $0.250 \text{ W/m}^2\text{K}$ for the renovated facades to $0.120 \text{ W/m}^2\text{K}$ for the more performant new facades.

The “Construction set” uses indicative parameters that refer to average values of high-performance, but still renovation technological solutions; the envelope performance that was considered for new construction has higher performance. All the selected stratigraphies

meet the minimum requirements established by the Minimum Environmental Criteria (CAM), introduced in Italy by Law No. 221 of 2015 [36].

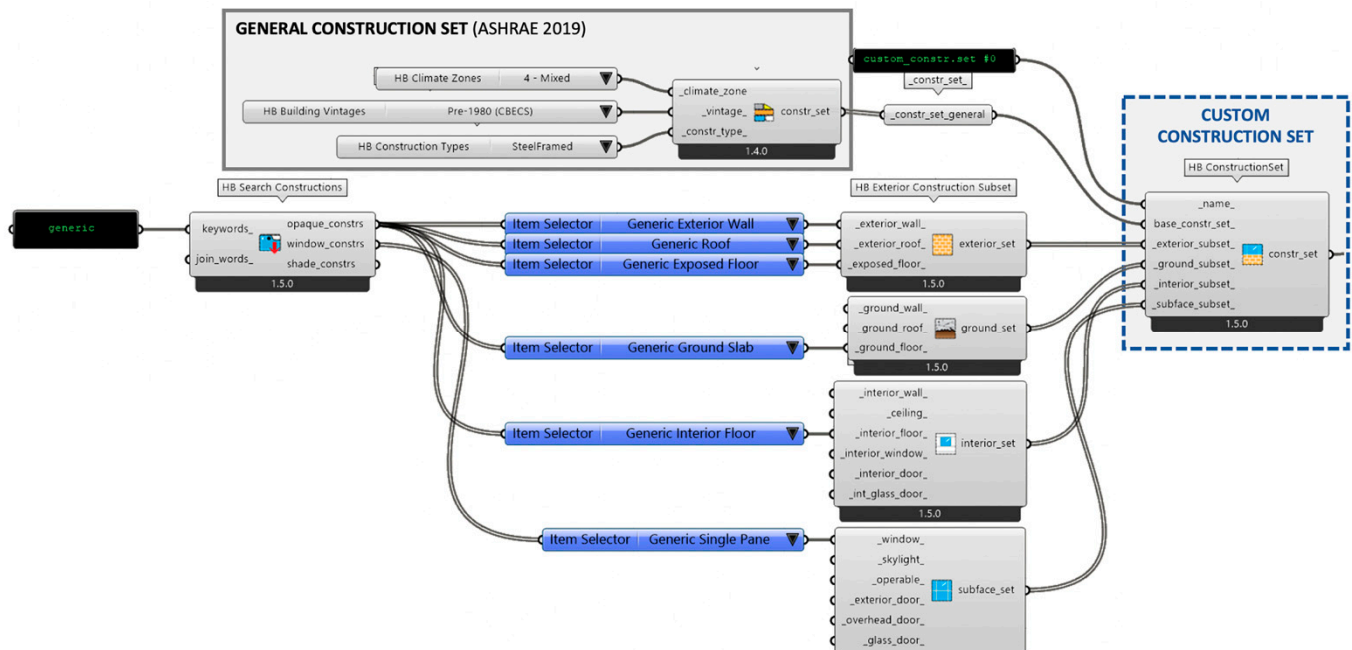

Figure 11. Input parameters considered in the *Dragonfly–Grasshopper* algorithm to define the “Construction set” describing the architectural elements of buildings: each set includes the layers sequence of each internal or external partition, characterized by specific mechanical and physic properties. Starting from the General Construction set based on the ASHRAE 2019, the algorithm has been customized according to standardized values for traditional/innovative construction solutions. (© 2023, C. Mazzoli after Q. Palazzo and P. Dabbicco).

Furthermore, *Dragonfly* needed the setting of precise “Programs”, which are data sets describing the intended uses, the times of use of the buildings and the consumption of the main systems (Figure 12). Specifically, for the simulations carried out, two personalized programs were created which refer to the state of the existing building (“Program-Current State”) and that of the deeply renovated building (“Program-Deep renovation”). Both programs start from the default program proposed for buildings intended for residential use characterized as Mid-rise Apartment by the ASHRAE programs, which then differ in the values of the parameters regarding electricity and gas consumption, losses due to thermal bridges, and the categories of HVAC systems. Table 1 reports the values considered for the two programs, defined according to standardized values reported in literature for traditional built heritage [37] used to carry out the energy simulations, whose results are shown in Figure 13.

For all the intervention scenarios analysed (Concept #0–COURTYARD, Concept #1, Concept #2, and Concept #3), the same “Program-Deep renovation” and the same “Construction set-Deep renovation” were used; indeed, they differ only in their geometry.

The comparison between the existing urban block and the different intervention scenarios (Figure 13) allowed us to assess the impact of possible energy upgrading strategies on the consumption of the current state. Although the variation in EUI value is minimal, the analyses show that, by using the same “Program” and “Construction set” for all the intervention scenarios, the more compact shape of the volumes leads to an improvement in the overall energy requirements. In conclusion, the Concept #0–COURTYARD scenario is the most efficient, with an EUI value of 123.90 kWh/m².

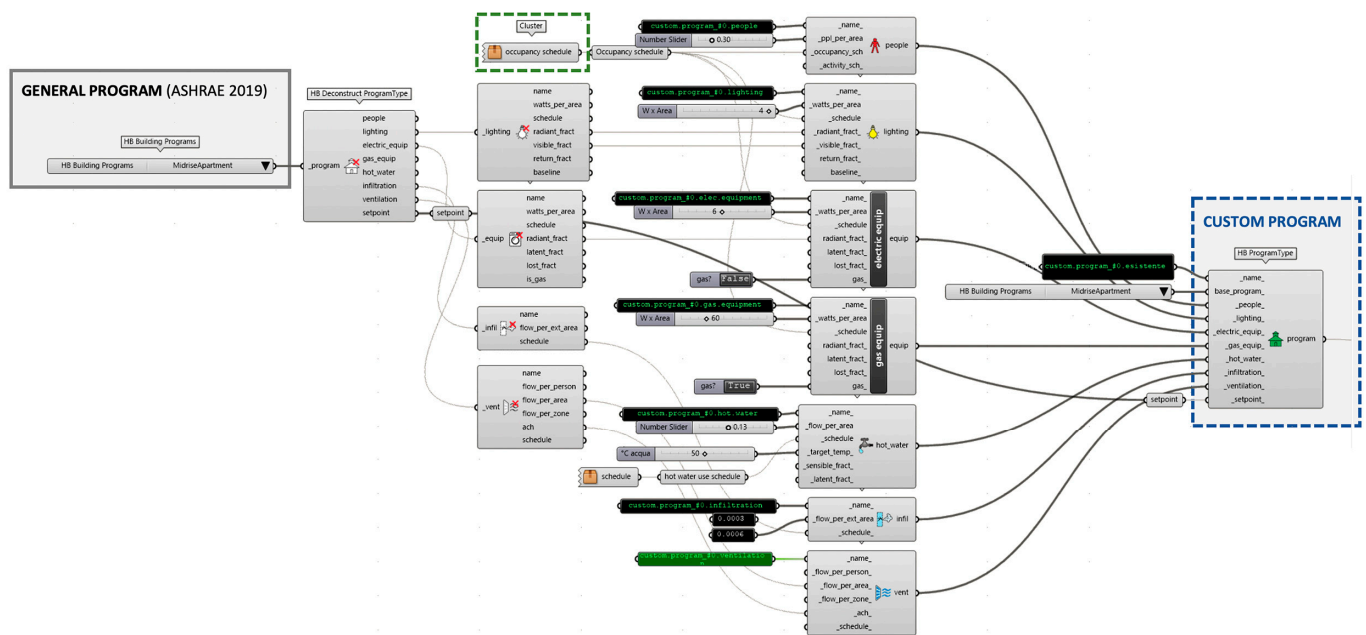

Figure 12. Input parameters considered in the *Dragonfly–Grasshopper* algorithm to define the “Programs” describing the characteristics and the use times of uses of buildings, as well as the consumption of the main system plants. Starting from the General Program based on the ASHRAE 2019, the algorithm has been customized according to ASHRAE standards for Mid-rise Apartment. (© 2023, C. Mazzoli after Q. Palazzo and P. Dabbicco).

Table 1. The values used for the two “Programs” and the simulation sheets summarizing the data, inputs, and results of the simulations.

Parameters	Program-Deep Renovation	Program-Current State
Base program	Mid-rise Apartment	Mid-rise Apartment
People	0.3 per m ²	0.3 per m ²
Lighting	3 W per m ²	4 W per m ²
Electric equipment	6 W per m ²	6 W per m ²
Gas equipment	6 W per m ²	10 W per m ²
Hot water	0.13 L/h per m ²	0.13 L/h per m ²
Ventilation	Generic	Generic
Infiltration	Tight Building 0.0001 m ³ /s per m ²	Leaky Building 0.0006 m ³ /s per m ²
Setpoint	From base program	From base program
HVAC system	Ideal Air Load (ASHRAE.2021)	Ideal Air Load (Pre.1980)

The comparison of the results shows that a significant reduction in building energy consumption is possible, mainly due to two factors. First, through retrofit of the building envelopes of the existing blocks to solve the lack of insulation in the infills. Second, through the infill and increased volume interventions which, by creating a “compact” morphological arrangement, significantly reduces the overall energy demand (EUI). That overall energy demand is, in its average values, always more than halved compared to the EUI of the current state of 263 kWh/m² year.

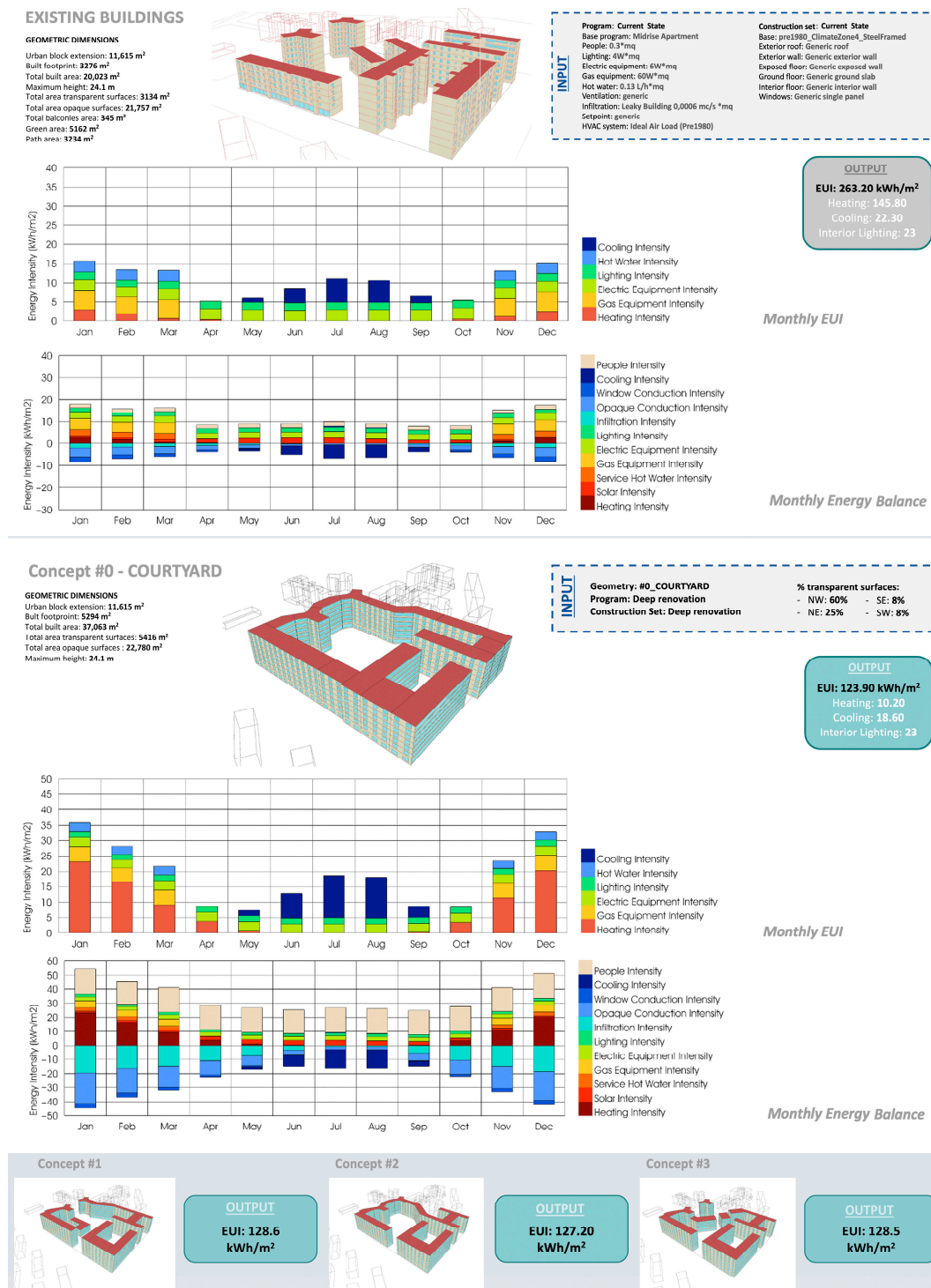

Figure 13. Analyses of the EUI values for the current state and different intervention scenarios: geometric characteristics, input data (referred to the “Construction set” and “Program” used in Dragonfly–Grasshopper, output data in terms of EUI (with the specific demand for heating, cooling, interior lighting (© 2023, C. Mazzoli after Q. Palazzo and P. Dabbicco).

4. Urban Re-Design Project

4.1. Definition of the Project Targets

After the context analyses were concluded, a meta-design approach was initially adopted on the case study, in which the strategic and theoretical guidelines for sustainable urban densification were resumed. Thanks to the parametric tools used, the architectural

and energy design objectives were monitored throughout the concept phase, with the intention of optimizing the design proposals, which were then detailed from a technological and systems point of view.

To manage the meta-design phase, the objectives of economic attractiveness of the intervention and energy self-sufficiency were defined through project targets. These were used as numerical indicators to quantitatively assess and compare the performance of different design scenarios. In fact, through the parameterization of the physical and performance characteristics of the new project volumes, it was possible to calculate in progress the relevant values concerning the set targets.

Specifically, two project targets were identified:

1. The first one is related to the profit from the investment, focusing on the economic feasibility of the intervention and the attractiveness for investors.
2. The second target focuses on the use of renewable energy sources, by sizing the PV area for energy self-sufficiency, monitoring the energy savings and finally quantifying the payback time of the investment.

Regarding the profit of the investment, ABRACADABRA has shown that the implementation of measures to increase urban density, through the volumetric expansion, helps to economically support the renovation of the entire building through the income generated. This contribution has an effect also at the urban scale, proposing a densification of the built environment through urban infill interventions. This can be particularly attractive, both for investors interested in new spaces, but also for the residents who can gain from the energy savings, the space addition and the increase in the commercial value of their property. Regarding the costs per m², data was taken from the *Prezzario della Regione Emilia-Romagna* of 2022 [38] and from the ABRACADABRA project database for each type of intervention. In addition, the gains obtained by the resale of nZEB buildings were considered through local market research for the area under study. A target return on investment was set, corresponding to profit over total investment set at a minimum of 15%.

4.2. Design Project Choices

The starting point of the design was the energy performance and bioclimatic potential derived from the comparison of the results between the current state and the Concept #0–COURTYARD hypothesis. The project was dedicated to achieving a condensed configuration for the new subdivision, aiming to facilitate the development of internal courtyards accessible to residents. To fulfil this objective, as mentioned in Section 3.2, the proposal involves the demolition of specific structures within the urban block. The identified elements for demolition include: the external stairwells of buildings 1 and 2, characterized by non-compliance as they were constructed later and did not meet standards; and the removal buildings 8 and 9, which is motivated by their unfavourable orientation and height, posing bioclimatic challenges and acting as an impediment to the establishment of usable outdoor areas (see Figure 5).

With respect to the Concept #0–COURTYARD hypothesis, the idea of implementing infill blocks to connect the existing pairs of buildings 1–2 and 3–4 was excluded. Buildings 1–2 are subject to historic preservation constraints. On the other hand, the intervention in buildings 3–4 would be too invasive for the related interior spaces, also negatively affecting the natural lighting levels.

Nonetheless, the numerous blind facades have strong potentials for infill intervention. Three new volumes (A, B, C) were considered useful to connect buildings 1, 7, and 6, as well as a new building contiguous to block 6 that would architecturally reset the facade of building 5 subject to demolition and allow its lost spaces to be recovered (Figure 14). Other volumetric increases have been planned as facade Add-ons, integrating an exoskeleton on the interior facades of buildings 1, 2, 3, and 4, to recover their vertical connections and to provide new spaces for residents in the form of balconies, verandas, and galleries. In any case, deep renovation is planned for all existing buildings that are not subject to demolition with the intention of reaching the nZEB target and improving their envelopes and systems.

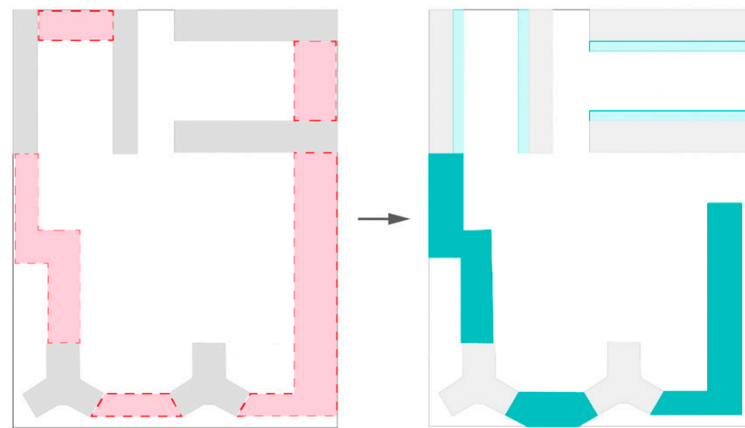

Figure 14. (Left) Plan of the hypothesis Concept #0-COURTYARD with the infill blocks in pink and (right) plan of the first intervention scenario with the infill and add-ons blocks in light blue. (© 2023, Q. Palazzo and P. Dabbicco).

For this first design scenario, indicators of profit and payback time of the investment were calculated in a preliminary manner. These preliminary results (see Tables 2 and 3) showed that the profit was very low: the considered average selling price per m² of about EUR 4100 has been multiplied by the total area increase of 5576 m² for a total profit of EUR 1,191,682, corresponding to an investment return rate of 5.49%.

Table 2. The values related to the energy and economic assessment of the final design solutions.

Parameters	Concept #0-COURTYARD	Final Design
Costs for Deep Renovation	260 EUR/m ²	260 EUR/m ²
Costs for new Add-ons on existing buildings (balconies)	400 EUR/m ²	400 EUR/m ²
Costs for new infill of building blocks	1500 EUR/m ²	1900 EUR/m ²
Housing infill building blocks-Income from selling	4100 EUR/m ²	4200 EUR/m ²
Commercial infill building blocks-Income from selling	-	4500 EUR/m ²
Housing infill building blocks-Total area	10,859.00 m ²	10,859.30 m ²
Commercial Infill blocks-Total area	-	3216.10 m ²
Infill blocks-Total area	10,859.00 m ²	14,075.40 m ²
Total increase in net floor area	5576 m ²	8757 m ²
Total Costs for Deep Renovation including demolitions	EUR 3,820,908	EUR 3,820,908
Costs for new Add-ons on existing buildings (balconies)	EUR 1,506,400	EUR 1,506,400
Total Costs for new infill of building blocks	EUR 16,342,200	EUR 26,743,260
Total income from increase in net floor area	EUR 22,861,190	EUR 37,742,130
Profit	EUR 1,191,682	5,671,562
Investment profit percentage	5.49%	17.68%

Table 3. The values related to the verification of project targets in terms of payback time and PVs quantification.

Parameters	Concept #0-COURTYARD	Final Design
Project End Use Intensity (<i>pEUI</i>)	75 kWh/m ² y	40 kWh/m ² y
Total energy demand-Current state	263 kWh/m ² y	263 kWh/m ² y

Table 3. Cont.

Parameters	Concept #0–COURTYARD	Final Design
Total energy demand–Existing blocks	5,263,866 kWh	5,263,866 kWh
Total energy demand–Deep renovated existing blocks	1,102,185 kWh	587,832 kWh
Total energy demand–After intervention	2,201,745 kWh	1,301,488 kWh
Peak kW (Bologna, Italy)	1400 kW	1400 kW
Peak PV 1 kW	4.15 m ²	4.15 m ²
Renewable Energy needed for deep renovated blocks	787 kWh	420 kWh
Total Renewable Energy needed	1573 kWh	930 kWh
PV area needed for deep renovated blocks	3267 m ²	1743 m ²
PV total area	6527 m²	3858 m²
Costs for PV systems	4.50 EUR/W	4.50 EUR/W
Costs for PV for deep renovation	EUR 3,542,738	EUR 1,889,460
Energy savings	188 kWh/m²y	223 kWh/m²y
Energy cost	0.50 EUR/kWh	0.50 EUR/kWh
Total costs	EUR 551,093	EUR 293,916
Bill savings	EUR 1,381,405	EUR 1,638,582
Payback time	2.56 y	1.15 y

Therefore, from the volumes considered, which were totally filled from ground to sky, the general morphology of the blocks was modified, in terms of height and plan shape of blocks A, B, and C (Figure 15). The infill buildings, named A, B, C, were shaped with the aim to increase the residential floor area by adding additional levels, especially at the corner building C. In addition, ground-floor openings were created in blocks A and B to facilitate access to the courtyard. The new volumes allowed for improved energy performance to come closer to the targets set (Table 2).

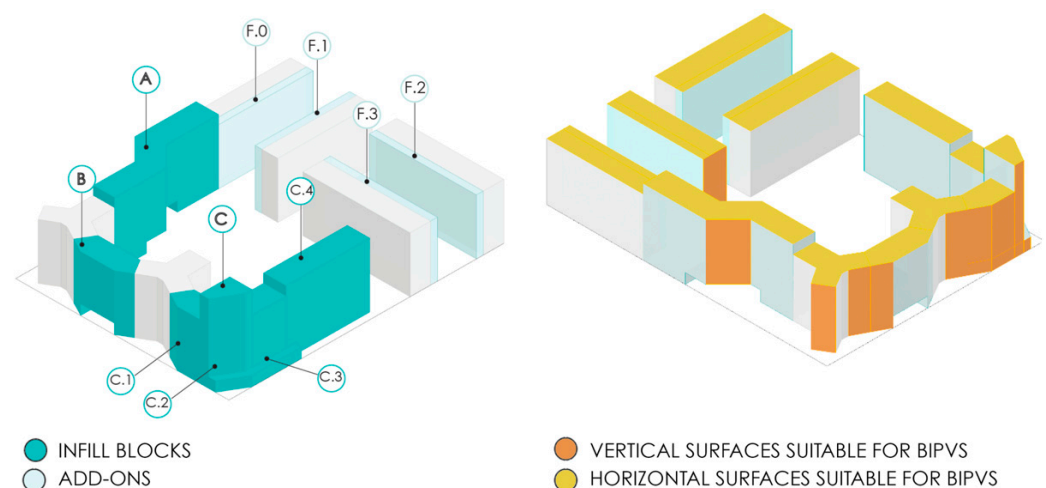

Figure 15. (Left) Axonometry of the final design solution selected, characterized by add-ons and infill blocks; (right) axonometry with visualization of facades and roofs suitable for PVs installation. (© 2023, C. Mazzoli after Q. Palazzo and P. Dabbicco).

Each of block A, B, and C was analysed individually through the use of *Ladybug*. Climate simulations were conducted to assess shading and incident radiation for the inner courtyard and critical facades in the block. The project targets on the new lot setting were then re-evaluated in order to further lower the benchmark *pEUI* for nZEBs (equal to 75 kWh/m²year, as indicated by NBI). The final design project includes a higher ratio of m²

of built-up area, which directly affects the profit generated from the resale of space: thus, it is guaranteed to exceed the minimum threshold of 15% set at the beginning of the project.

Regarding the dimensioning of the required PV area, incident radiation analyses have allowed for the more precise definition of the average peak radiation data for Bologna, resulting in a lowering of the required PV area, to be added to the surface area of the most favourable facades in terms of solar exposure, resulting in a total amount of 3858 m² of PV surface. The results on payback times are also positive, resulting in 1.15 years, due to the increase of 10% of the commercial area and of the sale profit of the new volumes. The target is thus achieved. Overall, in comparison with the current state of the district block, this proposed retrofit scenario will lead to a reduction of 75% of the total energy demand, now amounting to 1,301,488 kWh, and an energy savings of 223 kWh/m²y (Table 3).

The analyses carried out, together with current regulations, supported the selection of the specific solutions needed to achieve energy efficiency goals. Among the solutions studied, the following aspects were investigated in depth: structural technology, thermal and acoustic insulation, on-site energy supply, and reuse of energy through facilities that can fully meet the building's overall needs.

Regarding the energy aspects of the concept, it was possible to reassess and lower the estimated *pEUI* (from 75 kWh/m²y to 40 kWh/m²y) thanks the minimal energy consumption provided by extremely high performant solutions for the envelope (X-Lam panels and additional thickness of thermal insulating materials) (Figure 16). In particular, the following solutions were identified:

- Use of XLAM panels for the structural system and external envelope, chosen for its significant energy, static and environmental advantages.
- Installation of a PV system on roof and facade, sized to ensure the storage and supply of sufficient renewable energy for the autonomy of the new housing settlement.
- Implementation of a condominium thermal power plant system with heat pumps to supply the cooling, refrigeration and domestic hot water systems.
- Use of extensive green roofs on the roof for water recovery and beneficial effects in terms of reducing the heat island effect of the urban block and evapotranspiration for the large PV plant on the roof.

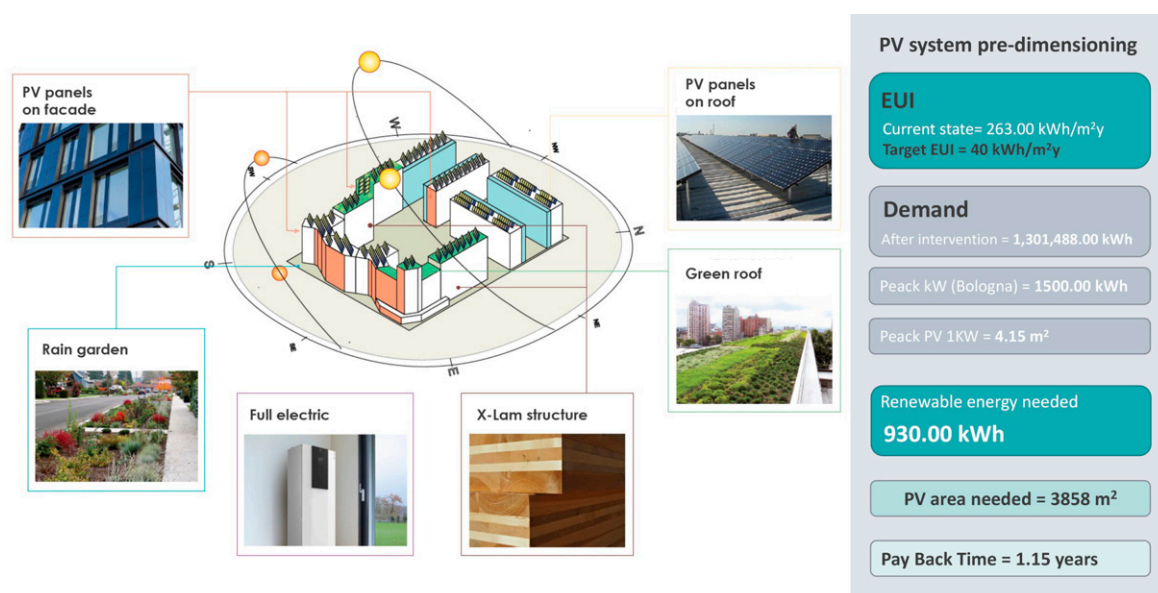

Figure 16. Overview of the different technological solutions implemented to achieve the project targets and data to verify them, in terms of energy efficiency and payback time. (© 2023, C. Mazzoli after Q. Palazzo and P. Dabbicco).

The main objective concerns the elimination of gas-fuelled plants to prefer the use of full-electric, in line with European directives to reduce CO₂ waste.

5. Conclusions

This paper seeks to illustrate the potential strategies for urban densification, employing a sustainable, and economically viable approach. It aligns with the successful model presented by the ABRACADABRA research project, extending its application to a larger scale of intervention beyond individual buildings. The practical efforts undertaken primarily concentrated on achieving energy self-sufficiency for an entire block of buildings located in San Donato district in Bologna. Maximizing economic gains through income generated by new construction, aimed at deep architectural and energy transformation.

The chosen block, identified for densification to create a zero-energy subdivision, possesses several advantageous qualities that align with the pursued strategies for urban infill. This implementation unfolded practically through a meta-design phase, wherein data collected during a multi-fold analysis played a crucial role in calibrating the entity of for the urban infill interventions and energy retrofit actions. This involved establishing numerical project targets that encapsulated the goals of substantial economic gain and a notable enhancement in energy performance of the area (reduction of 75% of the total energy demand, reaching beyond the EU and local regulation standards). Throughout the process, these project targets were continuously monitored and updated. The objective was to craft a design that effectively responded to the urban-scale strategies explored in this contribution, ensuring a harmonious integration of the densification and energy retrofit efforts. The proposed analysis and design method, with the use of parametric software to monitor performance requirements, can be replicated and applied to other similar urban contexts, allowing the test and validation of densification strategies. Although limited to a specific case study, the proposed design solutions demonstrate the technical and economic feasibility of urban regeneration aimed at implementing PEDs that might result in both attractive and profitable interventions for the environment, investors, and residents themselves.

The successful attainment of project target through this strategy underscores the effectiveness of interventions based on the combination of Add-ons and urban infill to enhance urban consolidated settlements, while avoiding further land consumption. Simultaneously, the commitment to deep renovation to align with current energy transformation objectives for existing stock contributes significantly to the broader European agenda. This collective effort aims to achieve climate-neutral cities in Europe by 2050, emphasizing the dual benefits of intensifying urban areas while meeting critical energy efficiency goals at both the local and continental levels.

The limitations of this densification strategy concern the possibility of adopting it only for non-historical building heritage, which is not protected by regulations in terms of reshape and deep renovation of the existing environment. Given the complexity and multiplicity of the criteria to be considered for achieving an optimized design solution, the proposed methodology is based on a multi-scalar and multi-criteria analysis, divided into different steps, supported by parametric digital tools. Further research development could consider the possibility of controlling the design process through the use of holistic digital platform combining and balancing all design criteria and solutions.

Author Contributions: Conceptualization, A.F.; methodology, C.M.; validation, C.M.; formal analysis C.M., D.P. and A.F.; design C.M.; investigation, A.F., C.M. and D.P.; data curation, C.M.; writing—original draft preparation, C.M.; writing—review and editing, C.M., D.P. and A.F.; supervision, A.F.; funding acquisition, A.F. (“ABRACADABRA” G.A. No 696126). All authors have read and agreed to the published version of the manuscript.

Funding: This research was funded by the EU Horizon 2020 Programme ABRACADABRA, G.A. No 696126 (<https://cordis.europa.eu/project/id/696126> (accessed on 14 December 2023)).

Data Availability Statement: Data are contained within the article.

Acknowledgments: The authors would like to thank Quilvia Palazzo and Pierpaolo Dabbicco for the contribution made in the framework of their master’s degree thesis, entitled, respectively, “Strategie di densificazione urbana per comparti a zero energia. Il caso di un nuovo edificio in via Virginia Reiter” and “Strategie di densificazione urbana per comparti a zero energia: Il caso dei nuovi edifici in via del Lavoro” (Alma Mater Studiorum—University of Bologna; tutor: Ferrante, A.; co-tutor: Mazzoli, C.).

Conflicts of Interest: The authors declare no conflict of interest.

References

1. Ingersoll, R. *Sprawltown, Looking for the City on Its Edges* Richard, 1st ed.; Thompson, J.N., Ed.; Princeton Architectural Press: New York, NY, USA, 2006; ISBN 9781568985664.
2. European Commission. *The European Green Deal*; European Commission: Brussels, Belgium, 2019.
3. European Parliament. Directive (EU) 2018/844 of the European Parliament and of the Council of 30 May 2018 Amending Directive 2010/31/EU on the Energy Performance of Buildings and Directive 2012/27/EU on Energy Efficiency. *Off. J. Eur. Union* **2018**, *276*, 75–91. [CrossRef]
4. European Parliament. Directive (EU) 2018/2001 of the European Parliament and of the Council of 11 December 2018 on the Promotion of the Use of Energy from Renewable Sources (Recast). *Off. J. Eur. Union* **2018**, *2018*, 82–209.
5. European Commission. *Future Brief: No Net Land Take by 2050?* European Commission: Brussels, Belgium, 2016; Volume 67.
6. European Commission Europe 2020: Commission Proposes New Economic Strategy in Europe. European Union Website 2010, 1–2. Available online: https://ec.europa.eu/commission/presscorner/detail/en/IP_10_225 (accessed on 14 December 2023).
7. ISPRA. *Il Consumo Di Suolo in Italia*; ISPRA: Ispra, Italy, 2015; ISBN 9788844807030.
8. Papadaki, D.; Nikolaou, D.A.; Assimakopoulos, M.N. Circular Environmental Impact of Recycled Building Materials and Residential Renewable Energy. *Sustainability* **2022**, *14*, 4039. [CrossRef]
9. European Commission. *Roadmap to a Resource Efficient Europe COM(2011) 571 Final*; European Commission: Brussels, Belgium, 2011; Volume COM (2011).
10. European Commission Science for Environment Policy. European Union Website 2016, 2. Available online: https://environment.ec.europa.eu/research-and-innovation/science-environment-policy_en (accessed on 14 December 2023).
11. Mastellone, M.; Ruggiero, S.; Papadaki, D.; Barmpareos, N.; Fotopoulou, A.; Ferrante, A.; Assimakopoulos, M.N. Energy, Environmental Impact and Indoor Environmental Quality of Add-Ons in Buildings. *Sustainability* **2022**, *14*, 7605. [CrossRef]
12. EEA. *Urban Sustainability Issues—What Is a Resource-Efficient City?* EEA: Copenhagen, Denmark, 2015; ISBN 9789292137106.
13. Williams, K. *Does Intensifying Cities Make Them More Sustainable?* Burton, E., Jenks, M., Williams, K., Eds.; E&FN Spon: London, UK, 2000; ISBN 9780203827925.
14. Vuckovic, M.; Loibl, W.; Tötzer, T.; Stollnberger, R. Potential of Urban Densification to Mitigate the Effects of Heat Island in Vienna, Austria. *Environments* **2019**, *6*, 82. [CrossRef]
15. Iacovantuono, A. *Urban Infill L’interpretazione Dei Vuoti Nella Città Compatta*, Sapienza Università di Roma. 2014. Available online: http://www.arc1.uniroma1.it/dottorato/composizione/architettonica/Dissertazioni/29_ArmandoIacovantuonoUrbanInfill.pdf (accessed on 14 December 2023).
16. European Commission. *Financial Support for Energy Efficiency in Buildings COM(2013) 225 Final*; European Commission: Brussels, Belgium, 2013; pp. 1–12.
17. European Parliament. *Directive 2012/27/EU of the European Parliament and of the Council of 25 October 2012 on Energy Efficiency*; European Parliament: Strasbourg, France, 2012; pp. 1–56.
18. Arbulu, M.; Oregi, X.; Etxepare, L.; Hernández-Minguillón, R.J. Barriers and Challenges of the Assessment Framework of the Commission Recommendation (EU) 2019/786 on Building Renovation by European RTD Projects. *Energy Build.* **2022**, *269*, 112267. [CrossRef]
19. European Commission. *Assistant Buildings’ Addition to Retrofit, Adopt, Cure and Develop the Actual Buildings up to ZeRo Energy, Activating a Market for Deep Renovation*; European Commission: Brussels, Belgium, 2016.
20. Ferrante, A.; Fotopoulou, A.; Semprini, G.; Cantelli, D.; Ruggiero, S.; Karalis, M.; Efthymiou, C.; Papadaki, D.; Assimakopoulos, M.N. IEQ and Energy Improvement of Existing Buildings by Prefabricated Facade Additions: The Case of a Student House in Athens. *IOP Conf. Ser. Mater. Sci. Eng.* **2019**, *609*, 042047. [CrossRef]
21. European Council. 12–13 December 2019, Main Results. Available online: <https://www.consilium.europa.eu/en/meetings/european-council/2019/12/12-13/> (accessed on 2 November 2023).
22. European Council Fit for 55—The EU’s Plan for a Green Transition—Consilium. Available online: <https://www.consilium.europa.eu/en/policies/green-deal/fit-for-55-the-eu-plan-for-a-green-transition/> (accessed on 14 December 2023).
23. Comune di Bologna Piano Urbanistico Generale Di Bologna. Available online: <http://dru.iperbole.bologna.it/piano-urbanistico-generale> (accessed on 2 November 2023).

24. Ministero Delle Imprese Decreto Ministeriale—Individuazione Della Tariffa Incentivante per La Remunerazione Degli Impianti a Fonti Rinnovabili Inseriti Nelle Configurazioni Sperimentali Di Autoconsumo Collettivo e Comunità Energetiche Rinnovabili. Available online: <https://www.mimit.gov.it/it/normativa/decreti-ministeriali/decreto-ministeriale-16-settembre-2020-individuazione-della-tariffa-incentivante-per-la-remunerazione-degli-impianti-a-fonti-rinnovabili-inseriti-nelle-configurazioni-sperimentali-di-autoconsumo-c> (accessed on 1 November 2023).
25. Regione Emilia-Romagna Piano Triennale Di Attuazione 2022–2024 Piano Energetico Regionale; 2017; pp. 1–123. Available online: <https://energia.regione.emilia-romagna.it/piani-programmi-progetti/programmazione-regionale/piano-energetico-per/piano-energetico-regionale#autotoc-item-autotoc-0> (accessed on 14 December 2023).
26. Emilia-Romagna. *Ervet Piano Energetico Regionale 2030 Emilia-Romagna*; 2017; p. 114. Available online: <https://energia.regione.emilia-romagna.it/piani-programmi-progetti/programmazione-regionale/piano-energetico-per/piano-energetico-regionale#autotoc-item-autotoc-0> (accessed on 14 December 2023).
27. Emilia-Romagna, A.L. della R. LEGGE REGIONALE 27 Maggio 2022, n. 5. 2022, n. 5, 1–6. Available online: <https://bur.regione.emilia-romagna.it/bur/area-bollettini/bollettini-in-lavorazione/n-162-del-27-05-2022-parte-prima.2022-05-27.2212115799/promozione-e-sostegno-delle-comunita-energetiche-rinnovabili-e-degli-autoconsumatori-di-energia-rinnovabile-che-agiscono-collettivamente/l-r-n-5-del-2022> (accessed on 14 December 2023).
28. Gazzetta Ufficiale Della Repubblica Italiana DECRETO LEGISLATIVO 8 Novembre 2021, n. 199 2021. Available online: <https://www.gazzettaufficiale.it/eli/id/2021/11/30/21G00214/sg> (accessed on 14 December 2023).
29. ART-ER Emilia-Romagna TRANSIZIONE ENERGETICA FONTI RINNOVABILI COMUNITÀ ENERGETICHE NEUTRALITÀ CARBONICA I Quaderni per La Transizione Energetica: Comunità Energetiche Rinnovabili e Gruppi Di Autoconsumatori. 2022. Available online: <https://energia.regione.emilia-romagna.it/notizie/notizie-home/2022/quaderno-comunita-energetiche-1.pdf> (accessed on 14 December 2023).
30. Milic, V.; Amiri, S.; Moshfegh, B. A Systematic Approach to Predict the Economic and Environmental Effects of the Cost-Optimal Energy Renovation of a Historic Building District on the District Heating System. *Energies* **2020**, *13*, 276. [CrossRef]
31. Abdrabo, K.I.; Hamed, H.; Fouad, K.A.; Shehata, M.; Kantoush, S.A.; Sumi, T.; Elboshy, B.; Osman, T. A Methodological Approach towards Sustainable Urban Densification for Urban Sprawl Control at the Microscale: Case Study of Tanta, Egypt. *Sustainability* **2021**, *13*, 5360. [CrossRef]
32. Huang, B.; Xing, K.; Pullen, S.; Liao, L. Exploring Carbon Neutral Potential in Urban Densification: A Precinct Perspective and Scenario Analysis. *Sustainability* **2020**, *12*, 4814. [CrossRef]
33. Hoffman, A.; Camagni, R.P.; Latella, F. *Mezzogiorno e Scienze Regionali: L'Analisi e La Programmazione*; Angeli, F., Ed.; Franco Angeli Edizioni: Milano, Italy, 1992.
34. Ruggiero, S.; Assimakopoulos, M.N.; De Masi, R.F.; De Rossi, F.; Fotopoulou, A.; Papadaki, D.; Vanoli, G.P.; Ferrante, A. Multi-Disciplinary Analysis of Light Shelves Application within a Student Dormitory Refurbishment. *Sustainability* **2021**, *13*, 8251. [CrossRef]
35. New Buildings Institute (NBI). Available online: <http://newbuildings.org/index.php?q=kpi> (accessed on 2 November 2023).
36. Decreto Legislativo. Disposizioni in Materia Ambientale per Promuovere Misure Di Green Economy e per Il Contenimento Dell'uso Eccessivo Di Risorse Naturali. *Gazz. Uff. Della Repub. Ital.* **2015**, *221*, 103.
37. Charan, T.; Mackey, C.; Irani, A.; Polly, B.; Ray, S.; Fleming, K.; El Kontar, R.; Moore, N.; Elgindy, T.; Cutler, D.; et al. Integration of Open-Source Urbanopt and Dragonfly Energy Modeling Capabilities into Practitioner Workflows for District-Scale Planning and Design. *Energies* **2021**, *14*, 5931. [CrossRef]
38. Regione, E.-R. Prezzario Delle Opere Pubbliche Della Regione Emilia-Romagna—Territorio. Available online: <https://territorio.regione.emilia-romagna.it/osservatorio/Elenco-regionale-prezzi/prezzari-regionali> (accessed on 2 November 2023).

Disclaimer/Publisher's Note: The statements, opinions and data contained in all publications are solely those of the individual author(s) and contributor(s) and not of MDPI and/or the editor(s). MDPI and/or the editor(s) disclaim responsibility for any injury to people or property resulting from any ideas, methods, instructions or products referred to in the content.